

T 23S, R 16E, M ~~10~~ W:1

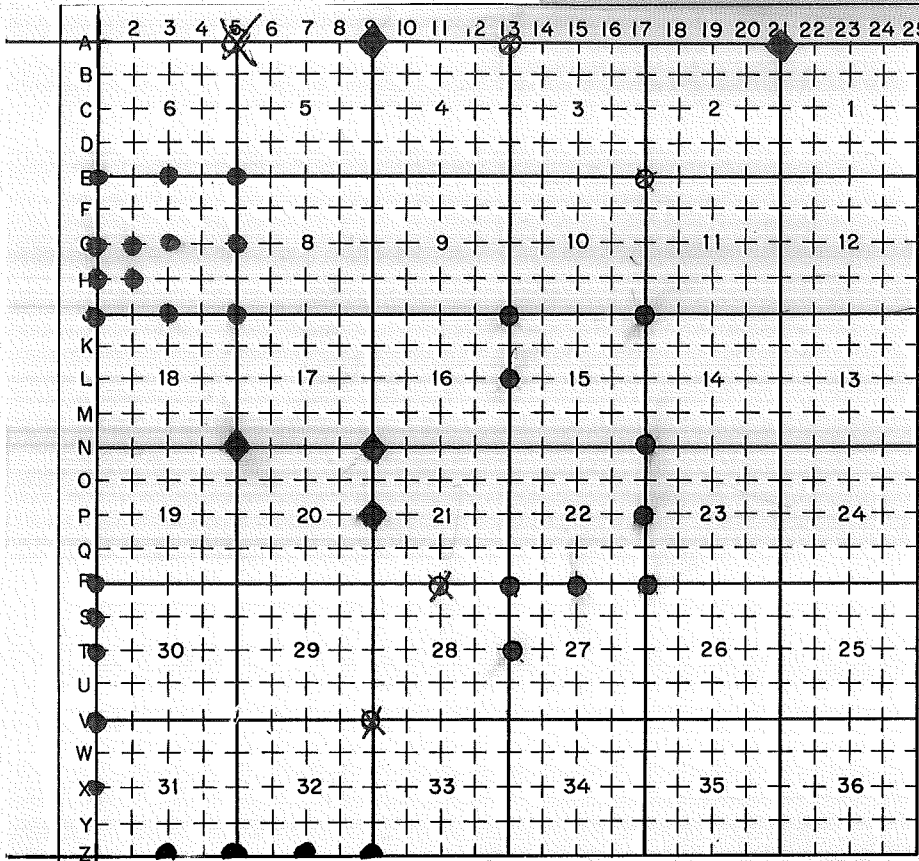

LEGEND

○ = Corner having information on form 7100-52 in this file.

LEGEND CONFORMS TO
REPORTING FORM MPB 2/80

FILING INSTRUCTION

File 7100-52 card record by letter and number coordinates behind the file guide for the township in which it falls.

File the 7100-52 card record by letter and then by number i.e., all A cards first, then B cards etc.

The first card behind the file guide (if data have been obtained and recorded) will be card A-1 for N.W. Township Corner, then card A-2 for 1/16 corner then card A-3 for 1/4 corner etc.

T 23S, R 16E, M ~~10~~ W:1

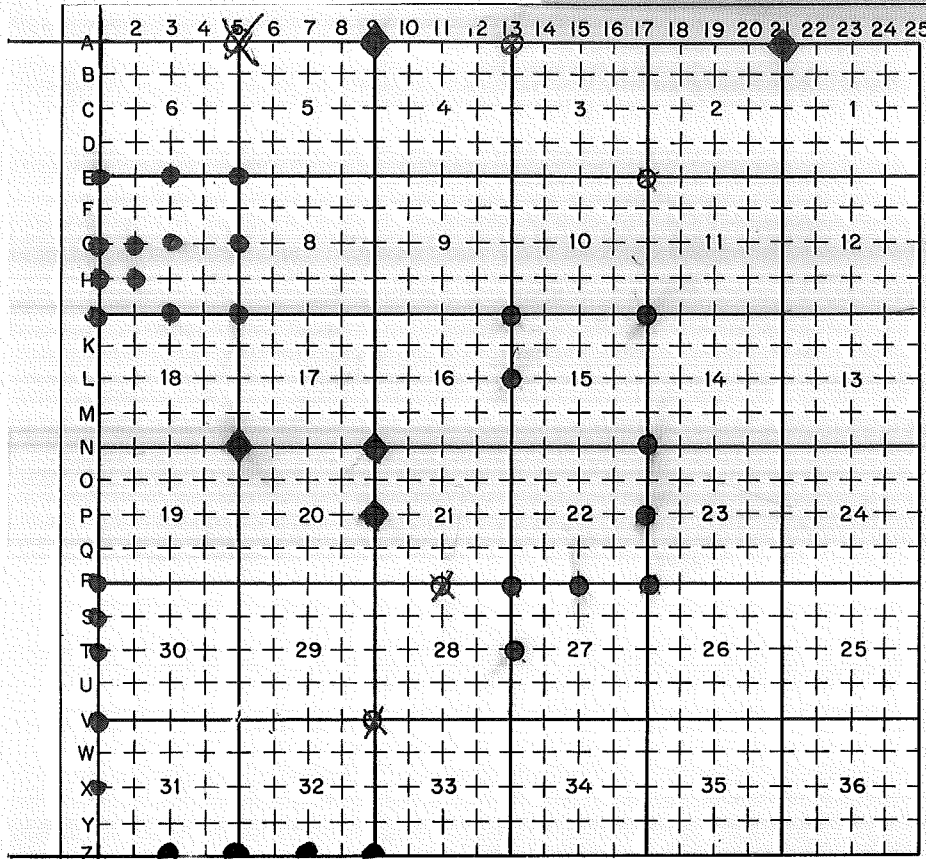

LEGEND

○ = Corner having information on form 7100-52 in this file.

Legend conforms to Reporting Form MPB 2/80

FILING INSTRUCTION

File 7100-52 card record by letter and number coordinates behind the file guide for the township in which it falls.

File the 7100-52 card record by letter and then by number i.e., all A cards first, then B cards etc.

The first card behind the file guide (if data have been obtained and recorded) will be card A-1 for N.W. Township Corner, then card A-2 for 1/16 corner then card A-3 for 1/4 corner etc.

Index

File No. 0551

CORNER RECORD (SEARCH)

(Ref. FSM 7151.4)

Contract or

Survey No. _____

Cor.
No.

A-05

T 23 S. R. 16 E. R.D.

Ft. Rock

County

Lake

NW

Cor. of

Merid. WILLAMETTE

N.F.

DESCHUTES

State

OREGON

Section

5

SEE: 2-05 T. 22 S., R. 16 E., W.M.

evidence found

12/22/87



LAND CORNER RECORD

A9

(Rectangular)

1. T. 23S R. 16E No. A-9 Cor. Sec. Mer. Wm. State Oregon N. F. Deschutes Dist. Fort Rock

2. Corner Status

3. Original Description _____ Vol. _____ Page _____ Where Recorded _____

4. Description of Corners:

5. Investigation Notes:

See Z-9 T22S R16E Wm.

7. Photo Identification

Photo No. _____

Ident. By: _____

8. Plane Coordinate Position Data

State _____ Zone _____

X _____

Y _____

Estab. By _____

Field Book No. _____

Where Filed _____

9. Evaluation

Authentic _____

Needs Verif. _____ Monument _____

Re-estab. _____ Survey _____

Land Status _____

6. Signed _____ Title _____ Date _____

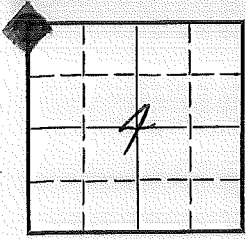

PERPETUATION RECORD

10. Monument:

11. Accessories

12. Set By _____ Title _____
License _____ Agency _____ Date _____

13. Recorded By _____ (Agency) _____ Volume _____ Page _____
(Date) (City) (County) (State)

14. Remarks:

Index
File No. _____
T 23 S. R. 16 E. R.D. _____
Merid. WILLAMETTE N.F. _____

CORNER RECORD (SEARCH)
(Ref. FSM 7151.4)

Tract or
Survey No. _____ Cor.
No. A-13

County _____
State OREGON

SEE:

T 225 R 16 E

Z-13

EV. FD

A-13

Index
File No. _____

CORNER RECORD (SEARCH)
(Ref. FSM 7151.4)

Tract or
Survey No. _____

Cor.
No. A-13

T 23 S. R. 16 E. R.D. _____ County _____

Merid. WILLAMETTE N.F. DESCHUTES State OREGON

SEE:

T 22S R16E

Z-13

EV. FD

A-13

LAND CORNER RECORD

A-21 5680-2

1. T 23S R 16E No. A-21 Cor. Sec Mer. Wm. State Oregon (Rectangular) N. F. Deschutes Dist. Fort Rock

2. Corner Status

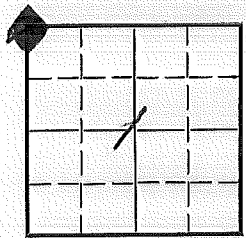

3. Original Description _____ Vol. _____ Page _____ Where Recorded _____

4. Description of Corners:

5. Investigation Notes:

See Z-21 T22S R16E Wm.

7. Photo Identification

Photo No. _____

Ident. By: _____

8. Plane Coordinate Position Data

State _____ Zone _____

X _____

Y _____

Estab. By _____

Field Book No. _____

Where Filed _____

9. Evaluation

Authentic _____

Needs Verif. _____ Monument _____

Re-estab. _____ Survey _____

Land Status _____

6. Signed _____ Title _____ Date _____

PERPETUATION RECORD

10. Monument:

11. Accessories

12. Set By _____ Title _____		Field Book _____	Page _____
License _____	Agency _____	Date _____	
13. Recorded By _____		Volume _____	Page _____
(Agency)			
(Date)	(City)	(County)	(State)

14. Remarks:

USDA-FOREST SERVICE

Index

File No. 0155

CORNER RECORD (SEARCH)

(Ref. FSM 7151.4)

Tract or

Survey No. 000833

Cor.

No. E-01

T 23 S. R. 16 E. R.D. FT. ROCK County LAKE CO NW COR S. 7

Merid. W.M. N.F. Deschutes State OR

CORNER DIAGRAM

T. 23 S.

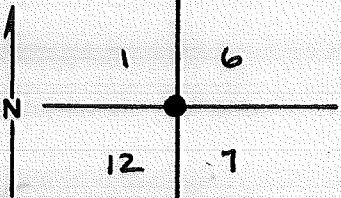

R. 17 E.

R. 16 E.

6

PHOTO IDENTIFICATION DATA

Photo No. _____

Filed At. _____

Object Ident. _____

Ident. By _____

Signature

7

PLANE COORDINATE POSITION DATA

State _____ Zone _____

X _____

Y _____

Estab. By _____

Agency

8

DESCRIBE CORNER MONUMENT FOUND

2

Evidence Found: Found a well-bedded stone 10x10x7 marked per original description. Original accessories found as follows: A rotted 30" stump with no scribing visible in the NE location. Rotted wood in the SE location. A 38" stump with no scribing visible in the SW location. A dead and down burnt tree with no visible scribing in the NW location.

3

DESCRIBE CORNER LOCATION RELATIVE TO NEAR-BY FEATURES, ALSO HOW TO REACH CORNER

4

Signature

Walt Miller

Title

PLS

Division

CS

Headquarters

SO

Date

3/91

FS-7100-52 (3/66)

5

CORNER RECORD (PERPETUATION)

MONUMENT: DESCRIBE NEW MONUMENT SET, OR WORK DONE TO PRESERVE EXISTING MONUMENT

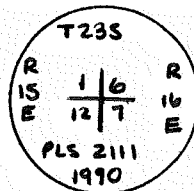

I set a 2-1/2" X 30" BCSP rising 5" in the place of the stone, and buried the stone along the N. side of the cap, from which I established the following accessories:

- A 10" PP bears N78°58'E at 180.0 ft., marked T23SR16ES6BT.
- A 12" PP " S55°18'E " 81.1 ft., " T23SR16ES7BT.
- A 17" PP " S26°57'W " 173.4 ft., " T23SR15ES12BT.
- A 6" PP " N10°14'W " 39.3 ft., " X BT.

RESERVE EXISTING EVIDENCE

Work Done By Walt Miller Title PLS Date 11/90 State Registration No. 2111
or Agency

Certified Cor. Record Prepared? Yes No Filed At: Lake Co. Date 3/7/91

REMARKS

Original Description: Set a basalt stone 11x10x7 for corner to sec.'s 1,6,7, and 12 marked with 1 notch on N., and 5 notches on S. faces. From which:
 A 15" Pine bears S35°E at 57 lks. A 36" Pine bears S09°W at 107 lks.
 A 24" Pine bears N25°W at 60 lks. A 30" Pine bears N37°E at 82 lks.

Index File No. 0155 T. 23 R. 16 M. 1 Tract or Surv. No. 000833 Cor. 91 E-01

USDA-FOREST SERVICE

Index
File No. 0355

CORNER RECORD (SEARCH)
(Ref. FSM 7151.4)

Tract or Survey No. 000833 Cor. No. E-03

T 23 S R. 16 E R.D. Ft. Rock County LAKE N/4 S. 7
Merid. WM N.F. Deschutes State OR

CORNER DIAGRAM

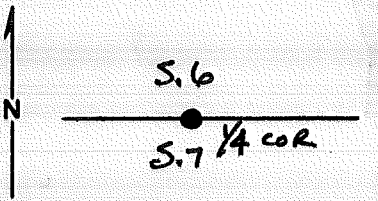

T23S-R.16E

PHOTO IDENTIFICATION DATA

Photo No. _____
Filed At. _____
Object Ident. _____
Ident. By _____
Signature

PLANE COORDINATE POSITION DATA

State _____ Zone _____
X _____
Y _____
Estab. By _____
Agency

DESCRIBE CORNER MONUMENT FOUND

SFNF - Area Logged & Burned

DESCRIBE BEARING TREES OR OTHER OFFICIAL ACCESSORIES FOUND

SFNF - Area logged & Burned.

DESCRIBE CORNER LOCATION RELATIVE TO NEAR-BY FEATURES, ALSO HOW TO REACH CORNER

Signature Walt Miller Title PLS Division CS Headquarters SO Date 3/91 FS-7100-52 (3/88)

CORNER RECORD (PERPETUATION)

MONUMENT: DESCRIBE NEW MONUMENT SET, OR WORK DONE TO PRESERVE EXISTING MONUMENT

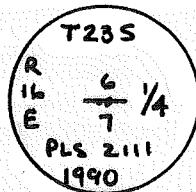

I set a 2-1/2" X 30" ACAP rising 6" in the proportioned position, from which I established the following accessories:

- A 11" PP bears N12°06'E at 26.3 ft., marked 1/4S6BT.
- A 6" PP " S08°33'E " 17.2 ft., " 1/4S7BT.
- A 9" PP " S36°35'W " 32.0 ft., " N1/4S7BT.
- A 13" PP " N37°50'W " 38.4 ft., " S1/4S6BT.

RESERVE EXISTING EVIDENCE

Work Done By Walt Miller Title PLS Date 11/90 State Registration No. 2111
or Agency

Certified Cor. Record Prepared? Yes No Filed At: Lake Co. Date 3/7/91

REMARKS

Original Description: Set a post 4 ft. long. 4" square with charred stake 12 ins. in the ground marked 1/4 on the N. face.

Index File No. 0355 T. 23 R. 16 M. Tract or Surv. No. 000833 Cor. E-03
GPO: 1986 O-439-095

USDA-FOREST SERVICE

Index

File No. 0555

CORNER RECORD (SEARCH)

(Ref. FSM 7151.4)

Tract or

000833

Cor.

No. E-05

T 23 S R. 16 E

R.D. Ft. Rock

County Lake

NE COR S. 7

Merid. WM

N.F. Deschutes

State OR

CORNER DIAGRAM

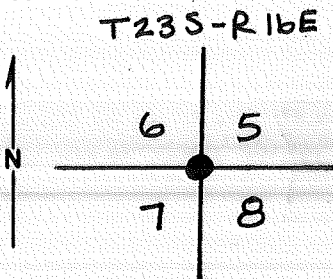

DESCRIBE CORNER MONUMENT FOUND

Evidence Found: I found no trace of the post. Original accessories found as follows: A 25" PP in the NE location with a healed over blaze, from which I cut out a plug to find 3SR16E as visible scribing. A decayed stump with an unattached blaze in the NW location. Rotted wood in the SE location.

PHOTO IDENTIFICATION DATA

Photo No. _____

Filed At. _____

Object Ident. _____

Ident. By _____

Signature

PLANE COORDINATE POSITION DATA

State _____ Zone _____

X _____

Y _____

Estab. By _____

Agency

DESCRIBE CORNER LOCATION RELATIVE TO NEAR-BY FEATURES, ALSO HOW TO REACH CORNER

Signature

Walt Miller

Title

PLS

Division

CS

Headquarters

SO

Date

3/91

FS-7100-52 (3/88)

CORNER RECORD (PERPETUATION)

MONUMENT: DESCRIBE NEW MONUMENT SET, OR WORK DONE TO PRESERVE EXISTING MONUMENT

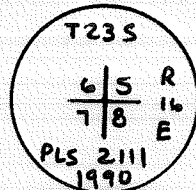

I set a 2-1/2" X 30" BCSP rising 5" from the record bearing and distance of the G.L.O., from which I established the following accessories:

- A 25" PP bears N10⁰⁰'E at 50.8 ft., marked as shown above. (Original)
- A 16" PP " S36¹⁴'E " 73.9 ft., " T23SR16ES8BT.
- A 9" PP " S16¹⁷'W " 41.5 ft., " T23SR16ES7BT.
- A 9" PP " N73⁰⁸'W " 25.0 ft., " T23SR16ES6BT.

RESERVE EXISTING EVIDENCE

Work Done By Walt Miller Title PLS Date 11/90 State Registration No. 2111 or Agency

Certified Cor. Record Prepared? Yes No Filed At: Lake Co. Date 3/7/91

REMARKS

Original Description: Set a post with pits and mounds from which:
 A 15" Pine bears N10⁰E at 77 lks. A 24" Pine bears S42³⁰'E at 32 lks.
 A 18" Pine bears N58³⁰'W at 60 lks.

Index File No.

0555

T.

23

R.

16

M.

GPO: 1986 O-439-095

Tract or Surv. No. 000833

Cor.

E-05

12

13

LAND CORNER RECORD

E-17 5680-2

(Rectangular)

1. T. 23S R. 16E No. E-17 Cor. Sec Mer. Wm. State Oregon N. F. Deschutes Dist. Fort. Rock

2. Corner Status

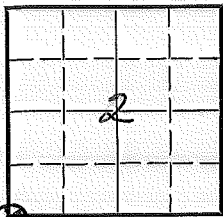

3. Original Description _____ Vol. _____ Page _____ Where Recorded _____

4. Description of Corners:

5. Investigation Notes: Stone 6" above ground with 5 grooves on S. side
2 grooves on E. side

loc. marker 924' W.

7. Photo Identification

Photo No. _____

Ident. By: _____

8. Plane Coordinate Position Data

State _____ Zone _____

X _____

Y _____

Estab. By _____

Field Book No. _____

Where Filed _____

9. Evaluation

Authentic X

Needs Verif. Monument No

Re-estab. Survey

Land Status F.S. & Private

6. Signed M.L.C. Title _____ Date 1959

PERPETUATION RECORD

10. Monument:

11. Accessories

		Field Book	Page
12. Set By _____	Title _____	13. Recorded By _____	Volume _____ Page _____
License _____	Agency _____	(Agency)	
Date _____		(Date) _____	(City) _____ (County) _____ (State) _____

14. Remarks:

USDA-FOREST SERVICE

Index
File No. 0157

CORNER RECORD (SEARCH)
(Ref. FSM 7151.4)

Tract or
Survey No. 000833 Cor.
No. G-01

T 23 S R. R 16 E R.D. Ft. Rock County Lake W/4 S.7

Merid. W.M. N.F. Deschutes State OR

CORNER DIAGRAM

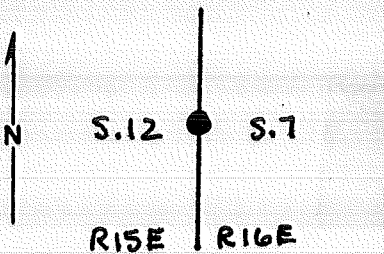

T2BS

DESCRIBE CORNER MONUMENT FOUND

Evidence Found: I found a bedded stone marked 1/4 on the East face measuring 2
17x12x7 with a stump in the record BT location that had no visible marks.

PHOTO IDENTIFICATION DATA

Photo No. _____
Filed At. _____
Object Ident. _____
Ident. By _____
Signature

DESCRIBE CORNER LOCATION RELATIVE TO NEAR-BY FEATURES, ALSO HOW TO REACH CORNER

PLANE COORDINATE POSITION DATA

State _____ Zone _____
X _____
Y _____
Estab. By _____
Agency

Signature
Walt Miller

Title
PLS

Division
CS

Headquarters
SO

Date
3/91

FS-7100-52 (3/88)

CORNER RECORD (PERPETUATION)

MONUMENT: DESCRIBE NEW MONUMENT SET, OR WORK DONE TO PRESERVE EXISTING MONUMENT

I set a 2-1/2" X 30" BCSP rising 6" in a stone collar in the place of the stone, and buried the stone along the W. side of the cap, from which I established the following accessories:

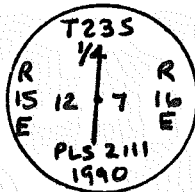

ACCESSORIES : DESCRIBE NEW BT'S WITNESS OBJECTS ETC. ESTABLISHED, OR WORK DONE TO PRESERVE EXISTING EVIDENCE

- A 7" PP bears N07⁰46'E at 2.4 ft., marked 1/4S7BT.
- A 10" PP " S23⁰03'E " 11.8 ft., " W/4S7BT.
- A 7" PP " S63⁰33'W " 7.3 ft., " 1/4S12BT.
- A 7" PP " N73⁰07'W " 13.8 ft., " E/4S12BT.

Work Done By Walt Miller Title PLS Date 11/90 State Registration No. 2111
or Agency

Certified Cor. Record Prepared? Yes No Filed At: Lake Co. Date 3/7/91

REMARKS

Original Description: Set a stone 18x12x7 marked 1/4 on the West face from which: A 15" Pine bears S07⁰W at 30 lks.

Index File No. 0157 T. 23 R. 16 M. Tract or Surv. No. 000833 Cor. 6-01

USDA-FOREST SERVICE

Index
File No. 0257

CORNER RECORD (SEARCH)
(Ref. FSM 7151.4)

Tract or Survey No. 000833 Cpr. No. G-02

T 23 S R. 16 E R.D. Ft. Rock County Lake CW/16 S.7
Merid. WM N.F. Deschutes State OR

CORNER DIAGRAM

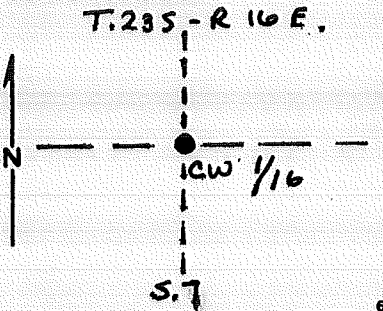

DESCRIBE CORNER MONUMENT FOUND

None Orig. Set.

DESCRIBE BEARING TREES OR OTHER OFFICIAL ACCESSORIES FOUND

None Orig. Set

PHOTO IDENTIFICATION DATA

Photo No. _____
Filed At. _____
Object Ident. _____
Ident. By _____
Signature

DESCRIBE CORNER LOCATION RELATIVE TO NEAR-BY FEATURES, ALSO HOW TO REACH CORNER

PLANE COORDINATE POSITION DATA

State _____ Zone _____
X _____
Y _____
Estab. By _____
Agency

Signature
Watt Miller

Title
PLS

Division
CS

Headquarters
SO

Date
3/91

FS-7100-52 (3/68)

CORNER RECORD (PERPETUATION)

MONUMENT: DESCRIBE NEW MONUMENT SET, OR WORK DONE TO PRESERVE EXISTING MONUMENT

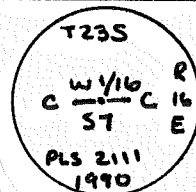

5) CENTER-WEST 1/16 CORNER SEC. 7:

A I set a 2-1/2" X 30" ACAP rising 7" from survey, from which I established the following accessories:

A 4" PP bears N36°44'E at 6.5 ft., marked CW1/16S7BT.

A 6" PP " S35°21'E " 19.8 ft., " CW1/16S7BT.

RESERVE EXISTING EVIDENCE

Work Done By. <u>Walt Miller</u>	Title <u>PLS</u>	Date <u>11/90</u>	State Registration No. or Agency <u>2111</u>	10
Certified Cor. Record Prepared? <input checked="" type="checkbox"/> Yes	No	Filed At: <u>Lake Co.</u>	Date <u>3/7/91</u>	11

REMARKS

Index File No. <u>0257</u>	T. <u>23</u>	R. <u>16</u>	M.	Tract or Surv. No. <u>000833</u>	Cor. <u>G-02</u>	12 13
----------------------------	--------------	--------------	----	----------------------------------	------------------	----------

GPO: 1986 O-439-095

USDA-FOREST SERVICE

Index
File No. 0357

CORNER RECORD (SEARCH)
(Ref. FSM 7151.4)

Tract or Survey No. 000833 Cor. No. G-03

T 20 S R. 16 E R.D. Ft. Rock County Lake
Merid. W.M. N.F. Deschutes State OR
C/A S.7

CORNER DIAGRAM

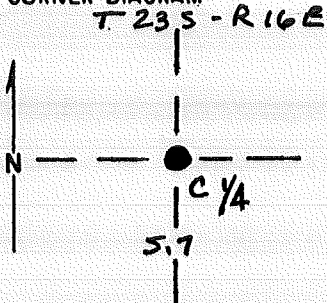

DESCRIBE CORNER MONUMENT FOUND

Not orig. set

DESCRIBE BEARING TREES OR OTHER OFFICIAL ACCESSORIES FOUND

Not orig. set

PHOTO IDENTIFICATION DATA

Photo No. _____
Filed At. _____
Object Ident. _____
Ident. By _____
Signature

DESCRIBE CORNER LOCATION RELATIVE TO NEAR-BY FEATURES, ALSO HOW TO REACH CORNER

PLANE COORDINATE POSITION DATA

State _____ Zone _____
X _____
Y _____
Estab. By _____
Agency

Signature
Walt Miller

Title
PLS

Division
CS

Headquarters
SO

Date
3/91

FS-7100-52 (3/68)

CORNER RECORD (PERPETUATION)

MONUMENT: DESCRIBE NEW MONUMENT SET, OR WORK DONE TO PRESERVE EXISTING MONUMENT

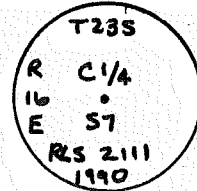

6) CENTER 1/4 CORNER SEC. 7:

I set a 2-1/2" X 30" ACAP rising 2" from survey, from which I established the following accessories:

A 14" PP bears N44°38'E at 46.8 ft., marked C1/4S7BT.

ACC

A 5/8" rebar with a 1-1/2" AC, marked B01 C1/4 S7 PLS2111 1990 bears N45°01'58"E at 26.60 ft.

A 5/8" rebar with a 1-1/2" AC, marked B02 C1/4 S7 PLS2111 1990 bears N46°04'38"E at 33.05 ft.

A 15" PP bears N62°43'E " 39.3 ft., marked C1/4S7BT.

SERVE EXISTING EVIDENCE

Work Done By Walt Miller Title PLS Date 11/90 State Registration No. 2111
or Agency

Certified Cor. Record Prepared? Yes No Filed At: Lake Co. Date 3/7/91

REMARKS

Index File No. 0357 T. 23 S R. 16 E M. GPO: 1986 0-439-095 Tract or Surv. No. 000833 Cor. G-03

USDA-FOREST SERVICE

Index
File No. 0557

CORNER RECORD (SEARCH)
(Ref. FSM 7151.4)

Tract or
Survey No. 000833 Cor.
No. G-OS

T 23 S R. 16 E R.D. Ft Rock County Lake E/4 S.7
Merid. W.M. N.F. Deschutes State OR

CORNER DIAGRAM

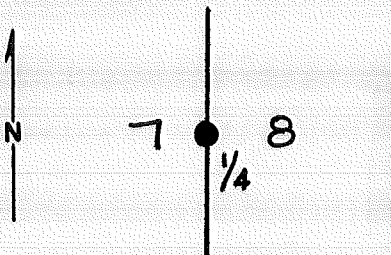

T. 23S - R. 16E

PHOTO IDENTIFICATION DATA

Photo No. _____
Filed At. _____
Object Ident. _____
Ident. By _____
Signature

PLANE COORDINATE POSITION DATA

State _____ Zone _____
X _____
Y _____
Estab. By _____
Agency

DESCRIBE CORNER MONUMENT FOUND

Evidence Found: I found a bedded stone measuring 14x12x7 marked 1/4 on the West face and a stump hole in the record BT location.

DESCRIBE CORNER LOCATION RELATIVE TO NEAR-BY FEATURES, ALSO HOW TO REACH CORNER

Signature
Walt Miller

Title
PLS

Division
CS

Headquarters
SO

Date
3/91

FS-7100-52 (3/68)

CORNER RECORD (PERPETUATION)

MONUMENT: DESCRIBE NEW MONUMENT SET, OR WORK DONE TO PRESERVE EXISTING MONUMENT

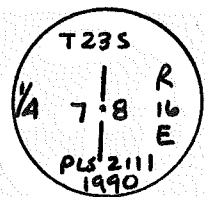

RESERVE EXISTING EVIDENCE

I set a 2-1/2" X 30" BCSP rising 6" in the place of the stone, and buried the stone along the N. side of the cap, from which I established the following accessories:

- A 4" PP bears N86°57'E at 23.7 ft., marked X BT.
- A 6" PP " S44°03'E " 63.5 ft., " 1/4S8BT.
- A 11" PP " S57°16'W " 88.3 ft., " 1/4S7BT.
- A 6" PP " N04°13'W " 38.9 ft., " E/4S7BT.

Work Done By Walt Miller Title PLS Date 11/90 State Registration No. 2111 or Agency _____ 10

Certified Cor. Record Prepared? Yes No Filed At: Lake Co. Date 3/7/91 11

REMARKS

Original Description: Set a stone 14x9x8 marked 1/4 on the West face with pits and mounds from which: A 8" Pine bears S01°W at 9 lks.

Index File No. OS57 T. T235 R. R16E M. _____ Tract or Surv. No. 000833 Cor. G-05 12
 GPO: 1986 O-439-095 13

USDA-FOREST SERVICE

Index
File No. 0158

CORNER RECORD (SEARCH)
(Ref. FSM 7151.4)

Tract or Survey No. 000833 Cor. No. H-01

T 23 S R. 16 E R.D. Ft. Rock County Lake 5/16 S.7
Merid. Wm. N.F. Deschutes State OR

CORNER DIAGRAM

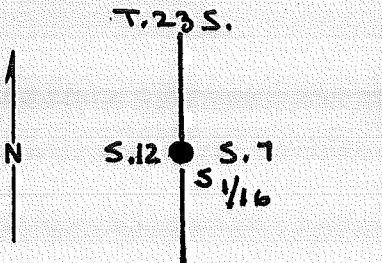

DESCRIBE CORNER MONUMENT FOUND

Not. Orig. Set.

DESCRIBE BEARING TREES OR OTHER OFFICIAL ACCESSORIES FOUND

Not Orig. Set.

R.15 E. R.16 E. 6

PHOTO IDENTIFICATION DATA

Photo No. _____
Filed At. _____
Object Ident. _____
Ident. By _____
Signature 7

DESCRIBE CORNER LOCATION RELATIVE TO NEAR-BY FEATURES, ALSO HOW TO REACH CORNER

PLANE COORDINATE POSITION DATA

State _____ Zone _____
X _____
Y _____
Estab. By _____
Agency 8

Signature
Walt Miller

Title
PLS

Division
CS

Headquarters
SO

Date
3/91

FS-7100-52 (3/68)

CORNER RECORD (PERPETUATION)

MONUMENT: DESCRIBE NEW MONUMENT SET, OR WORK DONE TO PRESERVE EXISTING MONUMENT

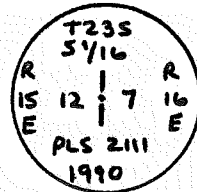

I set a 2-1/2" X 30" ACAP rising 8" from survey, from which I established the following accessories:

- A 15" PP bears S46°32'E at 55.0 ft., marked S1/16S7BT.
- A 18" PP " S20°14'W " 53.6 ft., " S1/16S12BT.

TO PRESERVE EXISTING EVIDENCE

Work Done By Walt Muller Title PLS Date 11/90 State Registration No. 2111
or Agency

Certified Cor. Record Prepared? Yes No Filed At: Lake Co. Date 3/7/91

REMARKS

Index File No. 0158 T. 235 R. 16E M. Tract or Surv. No. 000833 Cor. H-01

USDA-FOREST SERVICE

Index
File No. 0258

CORNER RECORD (SEARCH)
(Ref. FSM 7151.4)

Tract or Survey No. 000833 Cor. No. H-02

T 23 S. R. 16 E. R.D. Pt. Rock County Lake SW 1/16 S. 17
Merid. W.M. N.F. Deschutes State OR

CORNER DIAGRAM

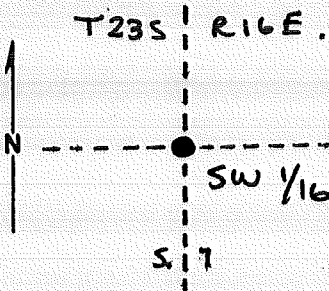

DESCRIBE CORNER MONUMENT FOUND

Not orig. Set

DESCRIBE BEARING TREES OR OTHER OFFICIAL ACCESSORIES FOUND

Not orig. Set

PHOTO IDENTIFICATION DATA

Photo No. _____
Filed At. _____
Object Ident. _____
Ident. By _____
Signature

PLANE COORDINATE POSITION DATA

State _____ Zone _____
X _____
Y _____
Estab. By _____
Agency

DESCRIBE CORNER LOCATION RELATIVE TO NEAR-BY FEATURES, ALSO HOW TO REACH CORNER

Signature
Walt Miller

Title
PL

Division
CS

Headquarters
SO

Date
3/91

FS-7100-52 (3/68)

CORNER RECORD (PERPETUATION)

MONUMENT: DESCRIBE NEW MONUMENT SET, OR WORK DONE TO PRESERVE EXISTING MONUMENT

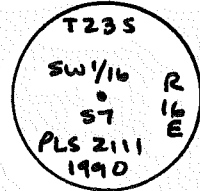

I set a 3-1/4" AC on a 5/8" rebar rising 7" in a rock mound from survey, from which I established the following accessories:
 A 4" PP bears N10°02"E at 61.7 ft., marked SW1/16S7BT.
 A 5/8" rebar with a 1-1/2" AC, marked B01 SW1/16 S7 PLS2111 1990 bears N62°57'00"E at 18.28 ft.

RESERVE EXISTING EVIDENCE

Work Done By Walt Miller Title PLS Date 11/90 State Registration No. 2111
 or Agency

Certified Cor. Record Prepared? Yes No Filed At: Lake Co. Date 3/7/91

REMARKS

Index File No. 025B T. 235 R. 16E J.M. Tract or Surv. No. 000833 Cor. H-02
 GPO: 1986 O-439-095

USDA-FOREST SERVICE

Index
File No. 0159

CORNER RECORD (SEARCH)
(Ref. FSM 7151.4)

Tract or
Survey No. 000833 Cor. No. J-01

T 23 S R. 16 E R.D. Ft. Rock County Lake SW Cor S.7
Merid. WM. N.F. Deschutes State OR

CORNER DIAGRAM

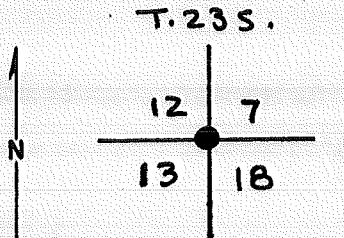

RISE R16E

PHOTO IDENTIFICATION DATA

Photo No. _____
Filed At. _____
Object Ident. _____
Ident. By _____
Signature

PLANE COORDINATE POSITION DATA

State _____ Zone _____
X _____
Y _____
Estab. By _____
Agency

DESCRIBE CORNER MONUMENT FOUND

Evidence Found: I found a well-bedded stone measuring 10x8x7 marked per the record. A 15" diameter stump marked BT in the SW location. A dead, down, and burnt tree marked T23SR in the SE location.

DESCRIBE CORNER LOCATION RELATIVE TO NEAR-BY FEATURES, ALSO HOW TO REACH CORNER

Signature
Walt Miller

Title
PL

Division
CS

Headquarters
SO

Date
3/91

FS-7100-52 (3/68)

CORNER RECORD (PERPETUATION)

MONUMENT: DESCRIBE NEW MONUMENT SET, OR WORK DONE TO PRESERVE EXISTING MONUMENT

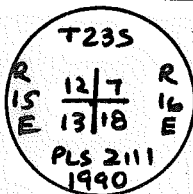

I set a 2-1/2" X 30" BCSP rising 6" in the place of the stone, and buried the stone along the W. side of the cap, from which I established the following accessories:

ACCESSORIES : DESCRIBE NEW BT'S WITNESS OBJECTS ETC. ESTABLISHED, OR WORK DONE TO PRESERVE EXISTING EVIDENCE

- A 5/8" rebar with a 1-1/2" AC, marked BO S7 PLS2111 1990 bears N44°44'28"E at 29.17 ft.
- A 17" PP bears S88°30'E at 115.4 ft., marked T23SR16ES18BT.
- A twin 9" and 11" PP bears S60°42'W at 88.9 ft., marked T23SR15ES13BT. (The 11" tree is blazed and scribed.)
- A 5/8" rebar with a 1-1/2" AC, marked BO S12 PLS2111 1990 bears N42°54'32"W at 24.31 ft.

Work Done By Walt Muller Title PLS Date 11/90 State Registration No. 2111
or Agency

Certified Cor. Record Prepared? Yes No Filed At: Lake Co. Date 3/7/91

REMARKS

Original Description: Set a stone 12x8x6 marked with 2 notches on N. and 4 notches on the S. edges, with pits and mounds from which: A 12" Pine bears S21°E at 25 lks. A 12" Pine bears S11°W at 35 lks.

Index File No. 0159 T. 23 R. S M. 16E Tract or Surv. No. 000833 Cop. J-01

USDA-FOREST SERVICE

Index
File No. 0359

CORNER RECORD (SEARCH)

(Ref. FSM 7151.4)

Tract or
Survey No. 000833 Gpr.
No. J-03

T 23 S. R. 16 E. R.D. Ft. Rock County Lake S/4 S. 7

Merid. WN. N.F. Deschutes State OR

CORNER DIAGRAM

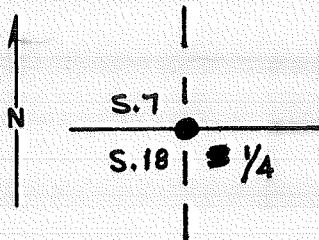

T23S R16E

PHOTO IDENTIFICATION DATA

Photo No. _____
Filed At. _____
Object Ident. _____
Ident. By _____
Signature

PLANE COORDINATE POSITION DATA

State _____ Zone _____
X _____
Y _____
Estab. By _____
Agency

DESCRIBE CORNER MONUMENT FOUND

Evidence Found: I found a well-bedded stone measuring 17x10x5 marked 1/4 on the N. face with a stone mound on the north side. A dead, down, and decayed tree with attached blaze marked 1/4SBT in the record SE location.

DESCRIBE CORNER LOCATION RELATIVE TO NEAR-BY FEATURES, ALSO HOW TO REACH CORNER

Signature

Walt Miller

Title

PLS

Division

CS

Headquarters

SO

Date

3/91

FS-7100-52 (3/68)

CORNER RECORD (PERPETUATION)

MONUMENT: DESCRIBE NEW MONUMENT SET, OR WORK DONE TO PRESERVE EXISTING MONUMENT

Set 2 1/2 BCSP

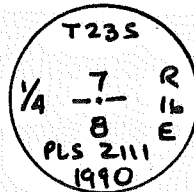

ACCESSORIES: DESCRIBE NEW BT'S WITNESS OBJECTS ETC. ESTABLISHED, OR WORK DONE TO PRESERVE EXISTING EVIDENCE

- A 7" PP bears N22°38'E at 77.7 ft., marked 1/4S7BT.
- A 12" PP " S09°59'E " 79.6 ft., " 1/4S18BT.
- A 7" PP " S13°49'W " 87.3 ft., " N/4S18BT.
- A 10" PP " N60°53'W " 111.5 ft., " S/4S7BT.

Work Done By Walt Miller Title Phs Date 11/90 State Registration No. 2111
or Agency

Certified Cor. Record Prepared? Yes No Filed At: Lake Co. Date 3/7/91

REMARKS

Original Description: Set stone 16x10x5 marked 1/4 on the North face with a mound of stone alongside from which: A 10" Pine bears S86°E at 27 lks.

Index File No. 0359 T. 235 R. 16E W.M. Tract or Surv. No. 000833 Cof. J-03

USDA-FOREST SERVICE

Index
File No. 0559

CORNER RECORD (SEARCH)

(Ref. FSM 7151.4)

Tract or Survey No. 000833 Cpr. No. J-05

T 23 S R. 16 E R.D. Ft. Rock County Lake SE COR S.7

Merid. WM. N.F. Deschutes State OR

CORNER DIAGRAM

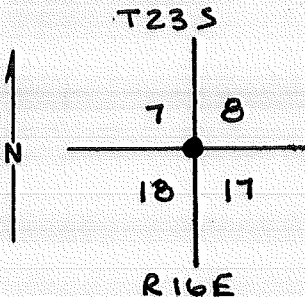

DESCRIBE CORNER MONUMENT FOUND

Evidence Found: I found a well-bedded stone measuring 16x7 marked per the GLO record in a small collar of stone.

DESCRIBE BEARING TREES OR OTHER OFFICIAL ACCESSORIES FOUND

SFNF

PHOTO IDENTIFICATION DATA

Photo No. _____
Filed At. _____
Object Ident. _____
Ident. By _____
Signature

DESCRIBE CORNER LOCATION RELATIVE TO NEAR-BY FEATURES, ALSO HOW TO REACH CORNER

PLANE COORDINATE POSITION DATA

State _____ Zone _____
X _____
Y _____
Estab. By _____
Agency

Signature
Walt Miller

Title
PLS

Division
CS

Headquarters
SO

Date
3/91

FS-7100-52 (3/68)

CORNER RECORD (PERPETUATION)

MONUMENT: DESCRIBE NEW MONUMENT SET, OR WORK DONE TO PRESERVE EXISTING MONUMENT

T235

7	8	R
18	17	16
PLS2111		E
1990		

I set a 2-1/2" X 30" BCSP rising 4" in the place of the stone, and buried the stone along the E. side of the cap, from which I established the following accessories:

A 5/8" rebar with a 1-1/2" AC, marked BO S8 PLS2111 1990 bears N66°35'22"E at 18.84 ft.

A 5/8" rebar with a 1-1/2" AC, marked BO S17 PLS2111 1990 bears S27°58'56"E at 23.67 ft.

A 5/8" rebar with a 1-1/2" AC, marked BO S18 PLS2111 1990 bears S55°14'46"W at 19.29 ft.

A 5/8" rebar with a 1-1/2" AC, marked BO S7 PLS2111 1990 bears N38°11'44"W at 21.51 ft.

SERVE EXISTING EVIDENCE

Work Done By Walt Miller Title PLS Date 1/1/90 State Registration No. 2111 or Agency

Certified Cor. Record Prepared Yes No Filed At: Lake Co. Date 3/7/91

REMARKS

Original Description: Set stone 16x12x7 marked with 4 notches on S. edge and 5 notches on the E. edge with pits and mounds.

Index File No. 0559 T. 235 R. 16E W.M. Tract or Surv. No. 000833 Cor. J-05

Index File No. J-13

CORNER RECORD (SEARCH)

(Ref. FSM 7151.4)

Tract or Survey No. _____

Cor. No. J-13

T 235 R. 16E

R.D. _____ County LAKE

Merid. WILL.

N.F. DESCHUTES State OREGON

CORNER DIAGRAM

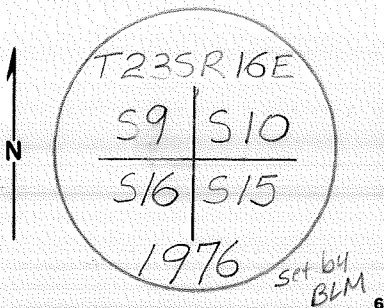

DESCRIBE CORNER MONUMENT FOUND

AT ORIG. COR. SECS 9, 10, 15 & 16, MON. BY JOHN W. MELDRUM IN 1882 WITH A BASALT STONE, 12" X 12" X 9" FOUND BURIED 5" BELOW SURFACE OF GRND. AT COR. PT., MKD. WITH 4 NOTCHES ON S. AND 3 NOTCHES ON E. EDGES.

DESCRIBE BEARING TREES OR OTHER OFFICIAL ACCESSORIES FOUND

A SAWED PINE STUMP, 34" DIA., 1 1/2' HIGH, BRS. S23°E 15 LKS. DIST. WITH ILLEG. SCRIBE MKS. VISIBLE ON 4' LONG SECTION OF SAWED LOG FOUND LYING APPROX. 30' N.E. OF TREE (PARTIALLY HEALED FACE). A SAWED PINE STUMP, 32" DIA., 1 1/2' HIGH, BRS. N44°W, 36 LKS. DIST. WITH ILLEG. SCRIBE MKS. VISIBLE ON PARTIALLY HEALED DOUBLE FACE ON 4' LONG SECTION OF SAWED LOG LYING APPROX. 4' N.W. OF BT. STUMP (SAW CUTS MATCH PERFECTLY ON STUMP & LOG PIECE)

PHOTO IDENTIFICATION DATA

Photo No. _____

Filed At. _____

Object Ident. _____

Ident. By _____

Signature

PLANE COORDINATE POSITION DATA

State _____ Zone _____

X _____

Y _____

Estab. By _____

Agency

Signature

Title

Division

Headquarters

Date

7100-52-(3/68)

DAN SANKWICH

SURVEY TECH.

7/76

CORNER RECORD (PERPETUATION)

MONUMENT: DESCRIBE NEW MONUMENT SET, OR WORK DONE TO PRESERVE EXISTING MONUMENT

AT COR. PT. SET A 2 1/2" x 28" I.P. 24" IN GRND.
ORIG. STONE DEPOS. ALONGSIDE I.P.
RAISE A MOUND OF STONE 2 1/2', BASE TO TOP OF I.P.

9

ACCESSORIES : DESCRIBE NEW BT'S WITNESS OBJECTS ETC. ESTABLISHED, OR WORK DONE TO PRESERVE EXISTING EVIDENCE

PINE, 4" DIA., BRS. N 79 1/4° E, 48 LKS, MKD. "X" AT BREAST HGT., B.T. AT BASE.
PINE, 4" DIA., BRS. S 29° E, 124 LKS, MKD. "X" AT BREAST HGT., B.T. AT BASE
PINE, 6" DIA., BRS. S 67° W, 172 LKS, MKD. T 23 S R 16 E S 16 BT
PINE, 4" DIA., BRS. N 3° W, 53 1/2 LKS, MKD. "X" AT BREAST HGT., B.T. AT BASE
NO OTHER B.T.'S AVAIL.

B.T. TAGS POSTED

10

Work Done By JOE GARRISON Title B.L.M. Date 7/76 State Registration No. or Agency _____

Certified Cor. Record Prepared? Yes No Filed At: _____ Date _____

11

REMARKS

Index File No.

T.

R.

M.

Tract or Surv. No.

Cor.

J-13

12

13

Index File No. J-17

CORNER RECORD (SEARCH)

(Ref. FSM 7151.4)

Tract or Survey No. _____

Cor. No. J-17

T 23S R. 16E

R.D. _____ County LAKE

Merid. WILL.

N.F. DESCHUTES State OREGON

CORNER DIAGRAM

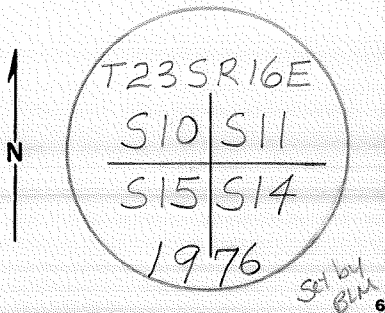

DESCRIBE CORNER MONUMENT FOUND AT ORIG. COR. SEC.'S 10, 11, 14 & 15 MON. BY JOHN W. MELDRUM IN 1882 WITH A BASALT STONE, 17" X 10" X 7" (BROKEN), (REC = 15" X 12" X 6") FOUND LYING LOOSELY ABOVE GRND. 2 LKS. WEST OF A 3 STRAND N-S BARBED WIRE FENCE LINE, WITH AN OLD MOUND OF STONE 2 1/2' BASE, 1 1/2' HIGH WEST OF COR. THE ORIG. STONE IS MARKED WITH 4 NOTCHES ON S. AND 2 ON E. SIDES. 2

DESCRIBE BEARING TREES OR OTHER OFFICIAL ACCESSORIES FOUND

A DOWN AND ROTTED PINE SNAG, 20" DIA., BRS. N 48 1/2° W (REC = N 51 1/2° W), 87 LKS. DIST., WITH AN OLD BLAZE (LYING FACE DOWN) OTHER B.T.'S GONE.

PHOTO IDENTIFICATION DATA

Photo No. _____

Filed At. _____

Object Ident. _____

Ident. By _____

Signature

7

DESCRIBE CORNER LOCATION RELATIVE TO NEAR-BY FEATURES, ALSO HOW TO REACH CORNER

LOCATED NEAR "THE PYRAMID"

PLANE COORDINATE POSITION DATA

State _____ Zone _____

X _____

Y _____

Estab. By _____

Agency

8

Signature

Title

Division

Headquarters

Date

DAN SANKWICH

SURVEY TECH.

7/76

7100-52-(3/68)

5

CORNER RECORD (PERPETUATION)

MONUMENT: DESCRIBE NEW MONUMENT SET, OR WORK DONE TO PRESERVE EXISTING MONUMENT

AT COR. PT. SET A 2 1/2" X 28" I.P. 20" IN GRND. TO SOLID ROCK, SMALL MOUND OF STONE.
ORIG. STONE DEPOS. ALONGSIDE I.P.

ACCESSORIES : DESCRIBE NEW BT'S WITNESS OBJECTS ETC. ESTABLISHED, OR WORK DONE TO PRESERVE EXISTING EVIDENCE

PINE, 4" DIA., BRS. S 88° W, 69 LKS. MKD. "X" AT BREAST HGT., "B.T." AT BASE.

PINE, 4" DIA., BRS. N 61 1/4° W, 63 1/2 LKS. DIST., MKD. "X" AT BREAST HGT., "B.T." AT BASE.

SINCE NO OTHER B.T.'S ARE AVAIL., I RAISE A MOUND OF STONE, 4' BASE 2' HIGH, WEST OF COR. B.T. TAGS POSTED

Work Done By JOE GARRISON Title B.L.M. Date 7/76 State Registration No. or Agency

Certified Cor. Record Prepared? Yes No Filed At: Date

REMARKS

Index File No.

T.

R.

M.

Tract or Surv. No.

Cor.

J-17

13

Index
File No. L-13

CORNER RECORD (SEARCH)

(Ref. FSM 7151.4)

Tract or
Survey No. _____

Cor.
No. L-13

T 235 R. 16E

R.D. _____ County LAKE

Merid. WILL.

N.F. DESCHUTES State OREGON

CORNER DIAGRAM

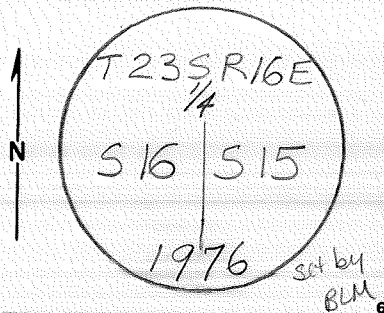

DESCRIBE CORNER MONUMENT FOUND

AT ORIG. 1/4 COR. SEC'S 15 & 16, DET. AT RECORD BEARING & DIST. FROM JOHN W. MELDRUM'S ORIG. 1882 B. T.'S

ORIG. STONE GONE

DESCRIBE BEARING TREES OR OTHER OFFICIAL ACCESSORIES FOUND

A PINE, 30" DIA., BRS. N 41° E, 30 LKS. DIST. WITH ILLEG. MKS. VISIBLE ON PARTIALLY HEALED BLAZE.

A PINE, 28" DIA., BRS. N 17° W (REC = N 12° W) 26 LKS. DIST. WITH SCRIBE MKS. "1/4 S" VISIBLE ON PARTIALLY HEALED BLAZE.

PHOTO IDENTIFICATION DATA

Photo No. _____
Filed At. _____
Object Ident. _____
Ident. By _____
Signature

DESCRIBE CORNER LOCATION RELATIVE TO NEAR-BY FEATURES, ALSO HOW TO REACH CORNER

FOREST SERV. RD. 2310

PLANE COORDINATE POSITION DATA

State _____ Zone _____
X _____
Y _____
Estab. By _____
Agency

FROM COR., $\frac{1}{2}$ OF CINDER RD., 20 LKS. WIDE, \odot BRS. N 40° W & S 40° E, BRS. E AT 88 LKS. DIST.

Signature

Title

Division

Headquarters

Date

7100-52 (3.68)

DAN SANKWICH

SURVEY TECH.

7/76

CORNER RECORD (PERPETUATION)

MONUMENT: DESCRIBE NEW MONUMENT SET, OR WORK DONE TO PRESERVE EXISTING MONUMENT

AT COR. PT. SET A 2 1/2" X 28" I.P. 24" IN GRND.

9

ACCESSORIES: DESCRIBE NEW BT'S WITNESS OBJECTS ETC. ESTABLISHED, OR WORK DONE TO PRESERVE EXISTING EVIDENCE

B. T. TAGS POSTED

10

Work Done By JOE GARRISON Title B.L.M. Date 7/76 State Registration No. or Agency

Certified Cor. Record Prepared? Yes No Filed At: Date

11

REMARKS

Index File No.

T.

R.

M.

Tract or Surv. No.

Cor.

L-13

12

13

LAND CORNER RECORD

N-5 5680-2

1. T 23S R 16E No. N-5 Cor. Sec Mer. Wm. State Oregon (Rectangular) N. F. Deschutes Dist. Fort Rock

2. Corner Status

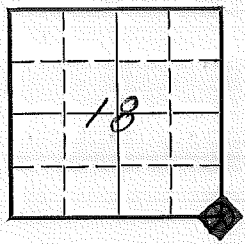

3. Original Description _____ Vol. _____ Page _____ Where Recorded Lake County

4. Description of Corners:
REMONUMENTATION: SEE BACK
 CONT. FROM BACK: 3S R16E S18 visible on open double blaze.
 2. A ponderosa pine, 16" diam., bears N. 37°30' W., 26.5 blks. dist.,
 with scribe marks R 16E S18 visible on open double blaze.

7. Photo Identification

Photo No. _____
Ident. By: _____

5. Investigation Notes:
 B.T. 18" P.P. scribed T23S R16E S 18
 18" " " " " ?
 18" " " " " ?
 8" P.P. snag scribed T23S R16E S 19

8. Plane Coordinate Position Data

State _____ Zone _____
X _____
Y _____
Estab. By _____
Field Book No. _____
Where Filed _____

9. Evaluation

Authentic _____
Needs Verif. _____ Monument No
Re-estab. X Survey _____
Land Status F.S.

6. Signed D. Callahan Title _____ Date 8/21/61/

PERPETUATION RECORD

T23SR16E
 S 18 | S 17
 S 19 | S 20
 1976

10. Monument:

Set an iron post, 28" long, 2½" diam., 24" in the ground,
 With Brass Cap marked.

Deposit corner stone alongside iron post.

11. Accessories

1. A ponderosa pine, 21" diam., bears N. 89°30' E., 59 lks. dist., mkd. T23SR16E S17 BT.
2. " " 6" " " S 37° 30' E., 132 lks., " " S20 BT.
3. " " 12" " " S 27° W., 44 lks. dist., " " S19 BT.

Corner is located 2 chains south of dirt road, 15 lks. wide, bears S. 53° E. and
 N. 45° W.

	Field Book _____ Page _____
12. Set By <u>J.J. Carlson</u> Title <u>Cadastral Surveyor</u>	13. Recorded By _____ Volume _____ Page _____
License _____ Agency <u>BLM</u> Date <u>LL/76</u>	(Agency)
	(Date) (City) (County) (State)

14. Remarks: The section corner monumented with the original basalt stone, 9x7x6", firmly set in ~~the~~ a mound of earth, 5Ft. diam., 1½ ft. high, mkd. X on top, and with dim pits, NE., SE., SW., and NW., 5½ ft. dist. from stone, from which the remains of the original bearing trees
1. A root hole, bears S. 86° W., 30 lks. dist., with a down pine alongside, 18" diam., with scribe marks 23S R16E S19 BT visible on open double blaze.
 2. A ponderosa pine, 15" diam., bears N. 56° W., 17 lks. dist., with scribe marks R16E S18 visible on open double blaze.
- And 2 bearing trees of which I have no record,
1. A ponderosa pine, 12" diam., bears N. 86° W., 25 lks. dist., with scribe marks

CONT. ON FRONT PAGE.

N-5

LAND CORNER RECORD

N-9 5680-2

1. T 23S R 16E No. N-9 Cor. Sec Mer. Wm. State Oregon N. F. Deschutes Dist. Fort Rock

2. Corner Status

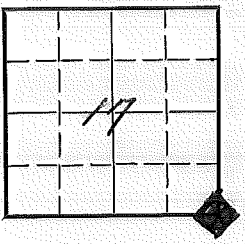

3. Original Description Vol. Page Where Recorded Lake County

4. Description of Corners: REMONUMENTATION: SEE BACK

7. Photo Identification

Photo No. _____
Ident. By: _____

8. Plane Coordinate Position Data

State _____ Zone _____
X _____
Y _____
Estab. By _____
Field Book No. _____
Where Filed _____

9. Evaluation

Authentic _____
Needs Verif. _____ Monument No _____
Re-estab. Survey _____
Land Status F.S. _____

5. Investigation Notes Stone 5" above ground, 3 / S. side, 4 / E. side (1959)
B.T. 16" P.P. stump scribed T23S R16E S 20
20" " " " " S 17
24" " " blaze grown over
20" " " blaze burned

6. Signed D. Callahan Title _____ Date 8/21/61

PERPETUATION RECORD

10. Monument: Set an iron post, 28" long, 2 1/2" diam., 22" in the ground.
With Brass Cap marked.

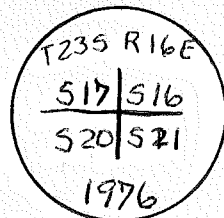

From which:

1. A pond

11. Accessories From which:

- | |
|---|
| 1. A ponderosa pine, 9" diam., bears N. 61°15' E., 110 lks. dist., mkd. T23S R16E S16 BT. |
| 2. " " 13" " " S. 63° E., 92 lks. " " S21 BT. |
| 3. " " 11" " " S. 85°15' W., 195 lks. # " S20 BT. |
| 4. " " 18" " " N. 50°15' W., 102 lks. " " S17 BT. |

Field Book _____ Page _____

12. Set By J.J. Carlson Title Cadastral Surveyor
License _____ Agency BLM Date 11/76

13. Recorded By _____ Volume _____ Page _____
(Agency)

(Date) (City) (County) (State)

14. Remarks: The section corner was determined at record bearing and distance from the remains of the original bearing trees.

1. A sawed ponderosa pine stump, 25" diam., bears S 78°30' W., 39 lks. dist., with scribe marks S 20 BT visible on open double blaze.
2. A sawed ponderosa pine stump, 18" diam., bears N. 81° W., 50 lks. dist., with scribe marks T23S R16E S17 BT visible on open and burned double blaze.

Also found 2 BT's of which I have no record.

1. A sawed ponderosa pine stump, 17" diam., bears S 84° W., 82 1/2 lks. dist., with scribe marks T23S R16E S20 BT visible on open double blaze.

2. A ponderosa pine, 19" diam., bears N. 71°30' W., 81 lks. dist., with fragmentary scribe marks visible on open and burned blaze.

Index File No. N-17

CORNER RECORD (SEARCH)

(Ref. FSM 7151.4)

Tract or Survey No. _____

Cor. No. N-17

T 235 R. 16E

R.D. _____ County LAKE

Merid. WILL.

N.F. DESCHUTES State OREGON

CORNER DIAGRAM

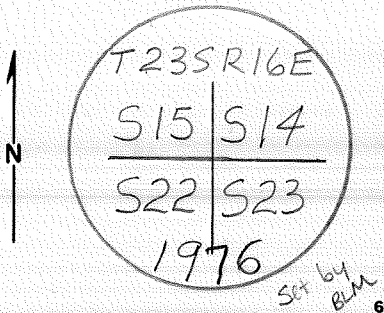

DESCRIBE CORNER MONUMENT FOUND

AT ORIG. COR. SEC'S 14, 15, 22, & 23, MON. BY JOHN W. MELDRUM IN 1882 WITH A BASALT STONE, 17" x 14" x 6", FIRMLY SET 9" IN GRND. IN SMALL MOUND OF STONE, MKD. WITH 3 NOTCHES ON SOUTH AND 2 NOTCHES ON EAST EDGES.

DESCRIBE BEARING TREES OR OTHER OFFICIAL ACCESSORIES FOUND

A PINE STUMP HOLE, WITH REMNANTS OF A PINE TREE SNAG LYING ON GROUND S.W. OF IT, BRS. S 23° W, 93 LKS. DIST.

PHOTO IDENTIFICATION DATA

Photo No. _____

Filed At. _____

Object Ident. _____

Ident. By _____

Signature 7

PLANE COORDINATE POSITION DATA

State _____ Zone _____

X _____

Y _____

Estab. By _____

Agency 8

DESCRIBE CORNER LOCATION RELATIVE TO NEAR-BY FEATURES, ALSO HOW TO REACH CORNER

FOREST SERV. RD. 2310

THE COR. FALLS IN A 3 STRAND BARBED WIRE FENCE LINE EXTENDING NORTH & SOUTH FROM THE COR., AN OLD DOWN BARBED WIRE FENCE LINE EXTENDS EAST FROM COR.

Signature

Title

Division

Headquarters

Date

7100-52-(3/68)

DAN SANKWICH

SURVEY TECH.

7/76

CORNER RECORD (PERPETUATION)

MONUMENT: DESCRIBE NEW MONUMENT SET, OR WORK DONE TO PRESERVE EXISTING MONUMENT

AT COR. PT, SET A 2 1/2" x 28" I.P. 22" IN GRND.
ORIG. STONE DEPOS. ALONGSIDE I.P. IN SMALL MOUND OF STONE

9

ACCESSORIES: DESCRIBE NEW BT'S WITNESS OBJECTS ETC. ESTABLISHED, OR WORK DONE TO PRESERVE EXISTING EVIDENCE

SINCE NO NEW B.T.'S ARE AVAIL. WITHIN 10 CH. OF COR. I
RAISED A MOUND OF STONE 4' BASE, 2' HIGH, WEST OF COR.

10

Work Done By JOE GARRISON Title B.L.M. Date 7/76 State Registration No.
or Agency

Certified Cor. Record Prepared? Yes No Filed At: Date

11

REMARKS

Index File No.

T.

R.

M.

Tract or Surv. No.

Cor.

N-17

12

13

LAND CORNER RECORD

P-9 5680-2

1. T. 23S R. 16E No. P-9 Cor. 7/4 Mer. Wm. State Oregon (Rectangular) N. F. Deschutes Dist. Fort Rock

2. Corner Status

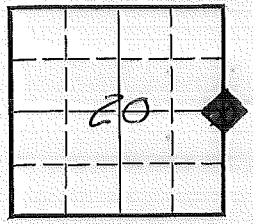

3. Original Description _____ Vol. _____ Page _____ Where Recorded Lake County

4. Description of Corners:
REMOUMENTATION: SEE BACK

5. Investigation Notes:

B.T. 24" P.P. Blaze burned
16" P.P. Blaze grown over

7. Photo Identification

Photo No. _____
Ident. By: _____

8. Plane Coordinate Position Data

State _____ Zone _____
X _____
Y _____
Estab. By _____
Field Book No. _____
Where Filed _____

9. Evaluation

Authentic _____
Needs Verif. _____ Monument No _____
Re-estab. Survey _____
Land Status F.S. _____

6. Signed D. Callahan Title _____ Date 8/21/61/

PERPETUATION RECORD

10. Monument: Set an iron post, 28" long, 2 1/2" diam., ~~XXXXXX~~ 22" in the ground, to bedrock, with Brass Cap marked.

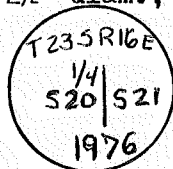

11. Accessories
A ponderosa pine, 13" diam., bears S. 25° E., 40 lks. dist., mkd. 1/4 S21 BT.

Field Book _____ Page _____

12. Set By J.J. Carlson Title Cadastral Surveyon
License _____ Agency BLM Date 11/76

13. Recorded By _____ Volume _____ Page _____
(Agency)

(Date) (City) (County) (State)

14. Remarks: 1/4 Corner determined at record bearing and distance from the original bearing trees:
1. A ponderosa pine, 36" diam., bears N. 54° E., 35 lks. Dist., with scribe mark B visible on open and burned blaze.
2. A. ponderosa pine, 18" diam., bears S. 76° W., 25 lks, dist., with healed blaze.

Index File No. P-17

CORNER RECORD (SEARCH)
(Ref. FSM 7151.4)

Tract or Survey No. _____
Cor. No. P-17

T 23S R. 16E

R.D. _____ County LAKE

Merid. WILL.

N.F. DESCHUTES State OREGON

CORNER DIAGRAM

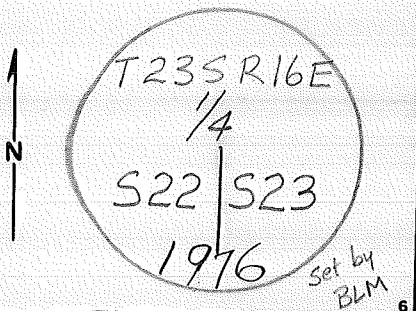

DESCRIBE CORNER MONUMENT FOUND

AT ORIG. $\frac{1}{4}$ COR. SEC'S 22 & 23, MON. BY JOHN W. MELDRUM IN 1882 WITH A SANDSTONE, 17" X 12" X 6", FIRMLY SET 11" IN GRND. MKD. " $\frac{1}{4}$ " ON W. FACE, (W) A SMALL MOUND OF STONE WEST OF COR.

DESCRIBE BEARING TREES OR OTHER OFFICIAL ACCESSORIES FOUND

A SAWED PINE STUMP, 20" DIA., $1\frac{1}{2}$ ' HIGH, BRS. S20°E, 94 LKS. DIST., NO MKS. VISIBLE.
A DOWN & ROTTED PINE SNAG, 22" DIA., BRS. N69 $\frac{1}{2}$ °W, 56 LKS. DIST., NO MKS. VISIBLE (SNAG LYING FACE DOWN)

PHOTO IDENTIFICATION DATA

Photo No. _____
Filed At. _____
Object Ident. _____
Ident. By _____
Signature _____ 7

DESCRIBE CORNER LOCATION RELATIVE TO NEAR-BY FEATURES, ALSO HOW TO REACH CORNER

LOCATED NEAR ASPEN FLAT
COR. FALLS IN A 3 STRAND BARBED WIRE FENCE LINE
EXTENDING NORTH & SOUTH.

PLANE COORDINATE POSITION DATA

State _____ Zone _____
X _____
Y _____
Estab. By _____
Agency _____ 8

Signature

DAN SANK WICH

Title

SURVEY TECH.

Division

Headquarters

Date

7/76

7100-52-(3/68)

Index
File No. P-17

CORNER RECORD (SEARCH)

(Ref. FSM 7151.4)

Tract or
Survey No. _____

Cor.
No. P-17

T 235 R. 16E

R.D. _____ County LAKE

Merid. WILL.

N.F. DESCHUTES State OREGON

CORNER DIAGRAM

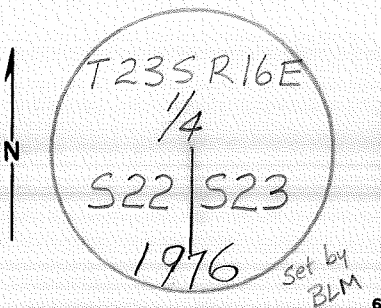

DESCRIBE CORNER MONUMENT FOUND

AT ORIG. 1/4 COR. SEC'S 22 & 23, MON. BY JOHN W. MELDRUM IN 1882 WITH A SANDSTONE, 17" X 12" X 6", FIRMLY SET 11" IN GRND. MKD. "1/4" ON W. FACE, (W) A SMALL MOUND OF STONE WEST OF COR.

DESCRIBE BEARING TREES OR OTHER OFFICIAL ACCESSORIES FOUND

A SAWED PINE STUMP, 20" DIA., 1 1/2' HIGH, BRS. S20°E, 94 LKS. DIST., NO MKS. VISIBLE.
A DOWN & ROTTED PINE SNAG, 22" DIA., BRS. N69 1/2°W, 56 LKS. DIST., NO MKS. VISIBLE (SNAG LYING FACE DOWN)

PHOTO IDENTIFICATION DATA

Photo No. _____
Filed At. _____
Object Ident. _____
Ident. By _____
Signature

DESCRIBE CORNER LOCATION RELATIVE TO NEAR-BY FEATURES, ALSO HOW TO REACH CORNER

LOCATED NEAR ASPEN FLAT
COR. FALLS IN A 3 STRAND BARBED WIRE FENCE LINE
EXTENDING NORTH & SOUTH.

PLANE COORDINATE POSITION DATA

State _____ Zone _____
X _____
Y _____
Estab. By _____
Agency

Signature
DAN SANKWICH

Title
SURVEY TECH.

Division _____

Headquarters _____

Date
7/76

CORNER RECORD (PERPETUATION)

MONUMENT: DESCRIBE NEW MONUMENT SET, OR WORK DONE TO PRESERVE EXISTING MONUMENT

AT COR. PT. SET A 2 1/2" X 28" I.P. 22" IN GRND.
RAISED A SMALL MOUND OF STONE AROUND I.P.
ORIG. STONE DEPOS. ALONGSIDE I.P.

ACCESSORIES: DESCRIBE NEW BT'S WITNESS OBJECTS ETC. ESTABLISHED, OR WORK DONE TO PRESERVE EXISTING EVIDENCE

PINE, 4" DIA., BRS. N 41 1/4° W, 49 LKS., MKD. "X" AT BREAST HGT.,
B. T. AT BASE.

SINCE NO OTHER B.T.'S ARE AVAILABLE, I RAISED A MOUND OF
STONE 3 1/2' BASE, 2' HIGH, WEST OF COR.

Work Done By JOE GARRISON Title B.L.M. Date 7/76 State Registration No. _____
or Agency _____

Certified Cor. Record Prepared? Yes No Filed At: _____ Date _____

REMARKS

Index File No.

T.

R.

M.

Tract or Surv. No.

Cor.

P-17

USDA-FOREST SERVICE

Index

File No. 0167

CORNER RECORD (SEARCH)

(Ref. FSM 7151.4)

Contract or

000832

Cor.

No. R-01T 23 S. R. 16 E. R.D.Ft Rock

County

LakeNW

Cor. of

Merid. WILLAMETTE

N.F.

DESCHUTES

State

OREGON

Section

30SEE: R-25 T. 23 S., R. 15 E., W.M.

BCSP



LAND CORNER RECORD

R-11 5680-2

(Rectangular)

1. T. 23S R. 16E No. R-11 Cor. 1/4 Mer. Wm. State Oregon N. F. Deschutes Dist. Fert Rock

2. Corner Status

3. Original Description Vol. Page Where Recorded

4. Description of Corners:

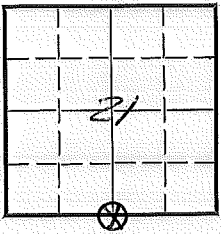

5. Investigation Notes: Stone 6" above ground
B.T. Sec. 21

7. Photo Identification

Photo No. _____
Ident. By: _____

8. Plane Coordinate Position Data

State _____ Zone _____
X _____
Y _____
Estab. By _____
Field Book No. _____
Where Filed _____

9. Evaluation

Authentic X
Needs Verif. Monument No
Re-estab. Survey
Land Status F.S.

6. Signed M.L.C. Title _____ Date 1959

PERPETUATION RECORD

10. Monument:

11. Accessories

12. Set By _____ Title _____	Field Book _____ Page _____
License _____ Agency _____ Date _____	13. Recorded By _____ Volume _____ Page _____ (Agency)
	(Date) (City) (County) (State)

14. Remarks:

R-11

Index File No. R-13 CORNER RECORD (SEARCH) (Ref. FSM 7151.4) Tract or Survey No. _____ Cor. No. R-13
 T 235 R. 16E R.D. _____ County LAKE
 Merid. WILL. N.F. DESCHUTES State OREGON

CORNER DIAGRAM

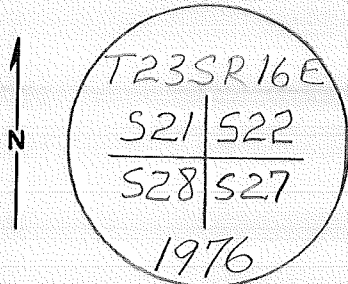

DESCRIBE CORNER MONUMENT FOUND

AT ORIG. COR. SEC.'S 21, 22, 27 & 28, MON. BY JOHN W. MELDRUM IN 1882 WITH A BASALT STONE, 20" X 9" X 8", FIRMLY SET 15" IN GRND., MKD. WITH 2 NOTCHES ON SOUTH & 3 NOTCHES ON EAST EDGES.

DESCRIBE BEARING TREES OR OTHER OFFICIAL ACCESSORIES FOUND

PHOTO IDENTIFICATION DATA

Photo No. _____
 Filed At. _____
 Object Ident. _____
 Ident. By _____
Signature

PLANE COORDINATE POSITION DATA

State _____ Zone _____
 X _____
 Y _____
 Estab. By _____
Agency

DESCRIBE CORNER LOCATION RELATIVE TO NEAR-BY FEATURES, ALSO HOW TO REACH CORNER

COR. FALLS 4 LKS. NORTH OF A BARBED WIRE FENCE CORNER, 3 STRAND, EXTENDING SOUTH AND EAST.

Signature DAN SANKWICH Title SURVEY TECH Division _____ Headquarters _____ Date 7/76

CORNER RECORD (PERPETUATION)

MONUMENT: DESCRIBE NEW MONUMENT SET, OR WORK DONE TO PRESERVE EXISTING MONUMENT

AT COR. PT. SET A $2\frac{1}{2}$ " x 28" I. P., 24" IN GRND.
 ORIG. STONE DEPOS. ALONGSIDE I.P.

ACCESSORIES : DESCRIBE NEW BT'S WITNESS OBJECTS ETC. ESTABLISHED, OR WORK DONE TO PRESERVE EXISTING EVIDENCE

PINE, 42" DIA., BRS. N $54\frac{1}{4}$ ° E 315 LKS., MKD. T 23 S R 16 E S 22 BT
 PINE, 17" DIA., BRS. S 58° E, 401 LKS., MKD. T 23 S R 16 E S 27 BT
 SINCE NO OTHER B.T.'S AVAILABLE I RAISE A MOUND OF STONE,
 4' BASE, $2\frac{1}{2}$ ' HIGH, WEST OF COR.

B. T. TAGS POSTED.

Work Done By JOE GARRISON Title B. L. M. Date 7/76 State Registration No. _____
 or Agency _____

Certified Cor. Record Prepared? Yes No Filed At: _____ Date _____

REMARKS

Index File No. 1 T. R. M. Tract or Surv. No. _____ Cor. R-13

Index
File No. R-15

CORNER RECORD (SEARCH)
(Ref. FSM 7151.4)

Tract or
Survey No. _____ Cor. No. R-15

T 23S R. 16E

R.D. _____ County LAKE

Merid. WILL.

N.F. DESCHUTES State OREGON

CORNER DIAGRAM

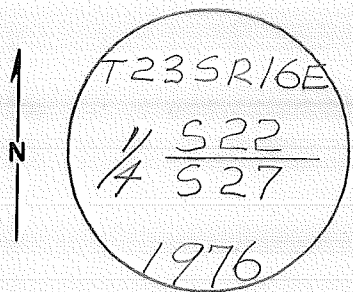

DESCRIBE CORNER MONUMENT FOUND

AT ORIG. $\frac{1}{4}$ COR., SEC.'S 22 & 27 MON. BY JOHN W. MELDRUM IN 1882 WITH A BASALT STONE, 17" X 12" X 3", FIRMLY SET 11" IN GRND. MKD. $\frac{1}{4}$ ON NORTH FACE WITH A MOUND OF STONE ON NORTH SIDE.

DESCRIBE BEARING TREES OR OTHER OFFICIAL ACCESSORIES FOUND

PHOTO IDENTIFICATION DATA

Photo No. _____
Filed At. _____
Object Ident. _____
Ident. By _____
Signature

DESCRIBE CORNER LOCATION RELATIVE TO NEAR-BY FEATURES, ALSO HOW TO REACH CORNER

A 3-STRAND BARBED WIRE FENCE LINE EXTENDING EAST AND WEST, PASSES DIRECTLY OVER CORNER.

LOCATED NEAR ASPEN FLAT

PLANE COORDINATE POSITION DATA

State _____ Zone _____
X _____
Y _____
Estab. By _____
Agency

Signature

Title

Division

Headquarters

Date

7100-52-(3/68)

DAN SANKWICH SURVEY TECH.

7/76

CORNER RECORD (PERPETUATION)

CONT: DESCRIBE NEW MONUMENT SET, OR WORK DONE TO PRESERVE EXISTING MONUMENT

COR. PT. SET A 2 1/2" X 28" I. P., 22" IN GRND. @ SMALL
OF STONE
1/2" STONE DEPOS. ALONGSIDE I. P.

NOTES: DESCRIBE NEW BT'S WITNESS OBJECTS ETC. ESTABLISHED, OR WORK DONE TO PRESERVE EXISTING EVIDENCE

E 15", BRS. S 35 1/4° E, 92 LKS., MKD. 1/4 S 27 BT
15", BRS. N 49 3/4° W, 101 LKS., MKD. 1/4 S 22 BT

B.T. TAGS POSTED

Prepared By: JOE GARRISON Title: B. L. M. Date: 7/76 State Registration No. or Agency: _____

Cor. Record Prepared? Yes No Filed At: _____ Date: _____

REMARKS

Section No. 1 T. 1 R. 1 M. 1 Tract or Surv. No. _____

Cor. R-1

—————

Index File No. R-17

CORNER RECORD (SEARCH)
(Ref. FSM 7151.4)

Tract or Survey No. _____ Cor. No. R-17

T 23S R. 16E

R.D. _____ County LAKE

Merid. WILL.

N.F. DESCHUTES State OREGON

CORNER DIAGRAM

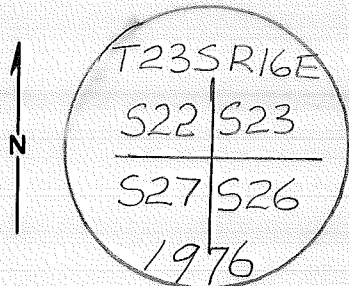

1 DESCRIBE CORNER MONUMENT FOUND AT ORIG. COR. SEC.'S 22, 23, 26 & 27 MON. BY JOHN W. MELDRUM IN 1882 WITH A SANDSTONE, 18" X 11" X 5" LYING LOOSELY ABOVE GRND., MKD. WITH 3 NOTCHES ON S. AND E. EDGES. A MOUND OF STONE, 2' BASE, 1 1/2' HIGH, FOUND WEST OF COR.

2 DESCRIBE BEARING TREES OR OTHER OFFICIAL ACCESSORIES FOUND A SAWED PINE STUMP, 18" DIA., 1' HIGH, BRS. N 83° E 38 LKS. DIST., NO MKS. VISIBLE. A STUMP HOLE BRS. S 1° E, 3 LKS. DIST. A DOWN & ROTTED PINE SNAG, 20" DIA., BRS. APPROX. 5 LKS. S.E. OF COR., WITH ILLEG. SCRIBE MKS. VISIBLE ON BADLY BURNED FACE. IT IS IMPOSSIBLE TO DETERMINE EXACT POSIT. SNAG WAS UPROOTED FROM SINCE IT HAS SLID DOWN HILL SOMEWHAT. IT APPEARS, HOWEVER, TO HAVE BEEN S.W. B.T. OTHER ORIG. B.T.'S GONE.

PHOTO IDENTIFICATION DATA

Photo No. _____
Filed At. _____
Object Ident. _____
Ident. By _____
Signature

3 DESCRIBE CORNER LOCATION RELATIVE TO NEAR-BY FEATURES, ALSO HOW TO REACH CORNER LOCATED NEAR COOK WELL & SQUAW BU.

PLANE COORDINATE POSITION DATA

State _____ Zone _____
X _____
Y _____
Estab. By _____
Agency

A FENCE COR. (W) A 3 STRAND B.W. FENCE LINE EXTENDING N. & W., BRS. N 68 1/4° E, 5 LKS. DIST.

Signature _____ Title _____ Division _____ Headquarters _____ Date 7/76

DAN SANKWICH SURVEY TECH.

Index File No. R-17

CORNER RECORD (SEARCH)
(Ref. FSM 7151.4)

Tract or Survey No. _____
Cor. No. R-17

T 235 R. 16E R.D. _____ County LAKE
Merid. WILL. N.F. DESCHUTES State OREGON

CORNER DIAGRAM

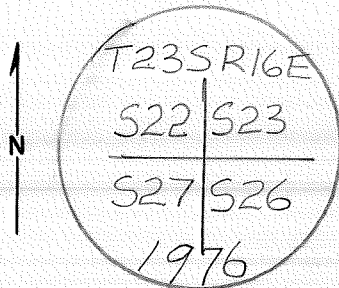

1 DESCRIBE CORNER MONUMENT FOUND AT ORIG. COR. SEC.'S 22, 23, 26 & 27 MON. BY JOHN W. MELDRUM IN 1882 WITH A SANDSTONE, 18" X 11" X 5", LYING LOOSELY ABOVE GRND. MKD. WITH 3 NOTCHES ON S. AND E. EDGES. A MOUND OF STONE, 2' BASE, 1 1/2' HIGH, FOUND WEST OF COR.

2 DESCRIBE BEARING TREES OR OTHER OFFICIAL ACCESSORIES FOUND A SAWED PINE STUMP, 18" DIA., 1' HIGH, BRs. N 83° E, 38 LKS. DIST., NO MKS. VISIBLE. A STUMP HOLE BRs. S 16° E, 3 LKS. DIST. A DOWN & ROTTED PINE SNAG, 20" DIA., BRs. APPROX. 5 LKS. S.E. OF COR., WITH ILLEG. SCRIBE MKS. VISIBLE ON BADLY BURNED FACE. IT IS IMPOSSIBLE TO DETERMINE EXACT POSIT. SNAG WAS UPROOTED FROM SINCE IT HAS SLID DOWN HILL SOMEWHAT. IT APPEARS, HOWEVER, TO HAVE BEEN S.W. B.T. OTHER ORIG. B.T.'S GONE.

6 **PHOTO IDENTIFICATION DATA**

Photo No. _____
Filed At. _____
Object Ident. _____
Ident. By _____
Signature

3 DESCRIBE CORNER LOCATION RELATIVE TO NEAR-BY FEATURES, ALSO HOW TO REACH CORNER

LOCATED NEAR COOK WELL & SQUAW BU.

8 **PLANE COORDINATE POSITION DATA**

State _____ Zone _____
X _____
Y _____
Estab. By _____
Agency

4 A FENCE COR. @ A 3 STRAND B.W. FENCE LINE EXTENDING N. & W., BRs. N 68 1/4° E, 5 LKS. DIST.

Signature DAN SANKWICH Title SURVEY TECH. Division _____ Headquarters _____ Date 7/76 7100-52-13-689

CORNER RECORD (PERPETUATION)

MONUMENT: DESCRIBE NEW MONUMENT SET, OR WORK DONE TO PRESERVE EXISTING MONUMENT

AT COR. PT. SET A 2 1/2" X 28" I.P. 18" IN GRND. TO SOLID ROCK.
ORIG. STONE DEPOS. ALONGSIDE I.P. IN MOUND OF STONE, 2 1/2' BASE TO
TOP OF I.P.

9

ACCESSORIES: DESCRIBE NEW BT'S WITNESS OBJECTS ETC. ESTABLISHED, OR WORK DONE TO PRESERVE EXISTING EVIDENCE

PINE, 10" DIA., BRS. S 52° E, 162 LKS. DIST., MKD T23SR16E S26 BT
NO OTHER B.T.'S AVAIL.

RAISE A MOUND OF STONE 3 1/2' BASE, 2 1/2' HIGH, WEST OF COR.
B.T. TAG POSTED

10

Work Done By JOE GARRISON Title B. L. M. Date 7/76 State Registration No. or Agency

Certified Cor. Record Prepared? Yes No Filed At: _____ Date _____ 11

REMARKS

Index File No.

T.

R.

M.

Tract or Surv. No.

Cor.

R-17

12

13

USDA-FOREST SERVICE

Index

File No. 0168

CORNER RECORD (SEARCH)

(Ref. FSM 7151.4)

Contract or

000832

Cor.

No. S-01

T 23 S. R. 16 E. R.D.

Ft Rock

County

Lake

N 1/16

Cor. of

Merid. WILLAMETTE

N.F.

DESCHUTES

State

OREGON

Section

25/30

SEE: S-25 T. 23 S., R. 15 E., W.M.

BOSP

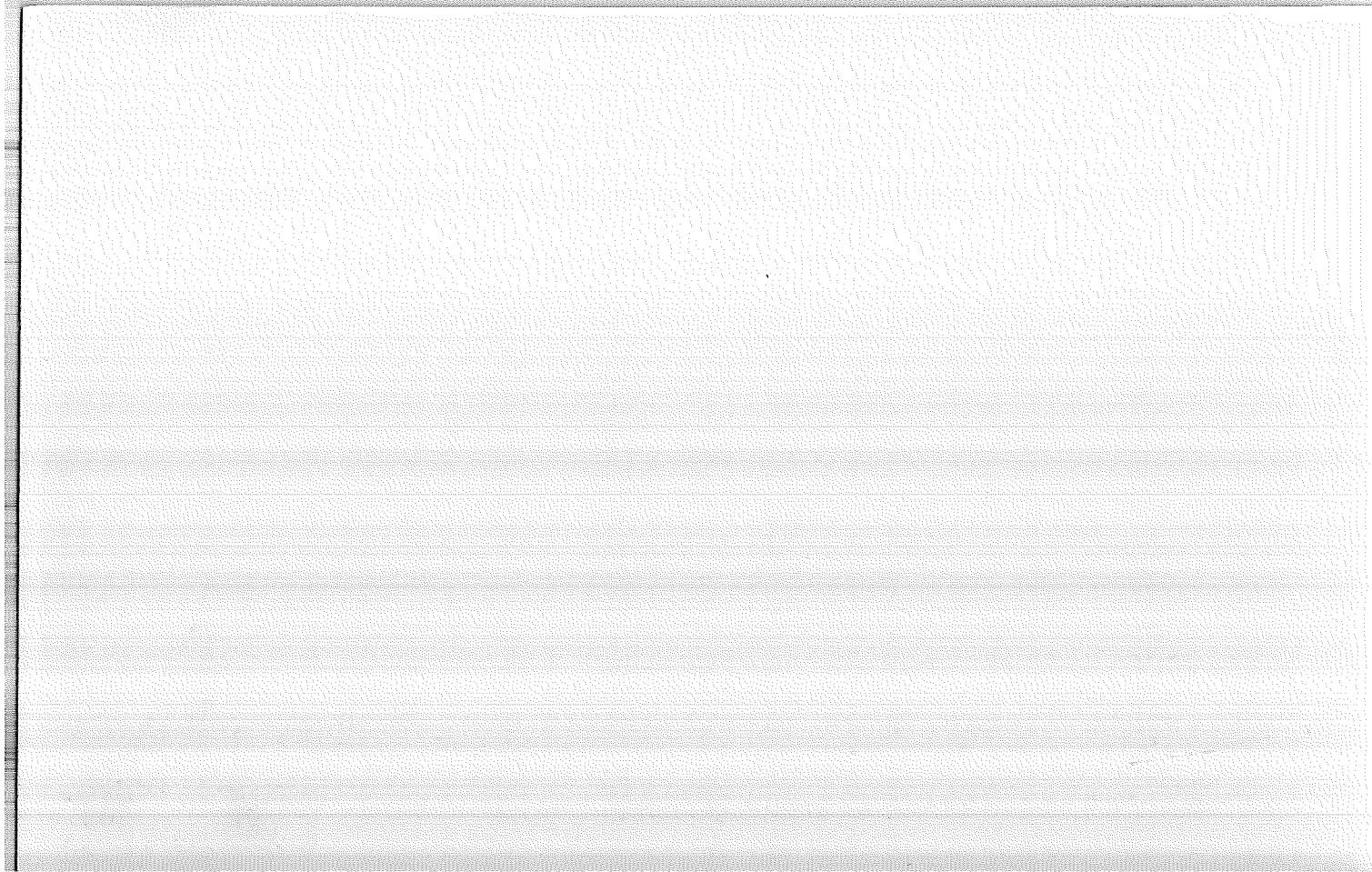

Index
File No. 0169 CORNER RECORD (SEARCH) Contract or
(Ref. FSM 7151.4) Survey No. 000832 Cor. No. T-01
T 23 S. R. 16 E. R.D. Ft Rock County Lake W/A Cor. of
Merid. WILLAMETTE N.F. DESCHUTES State OREGON Section 30

SEE: T-25 T. 23 S., R. 15 E., W.M.

BCSP

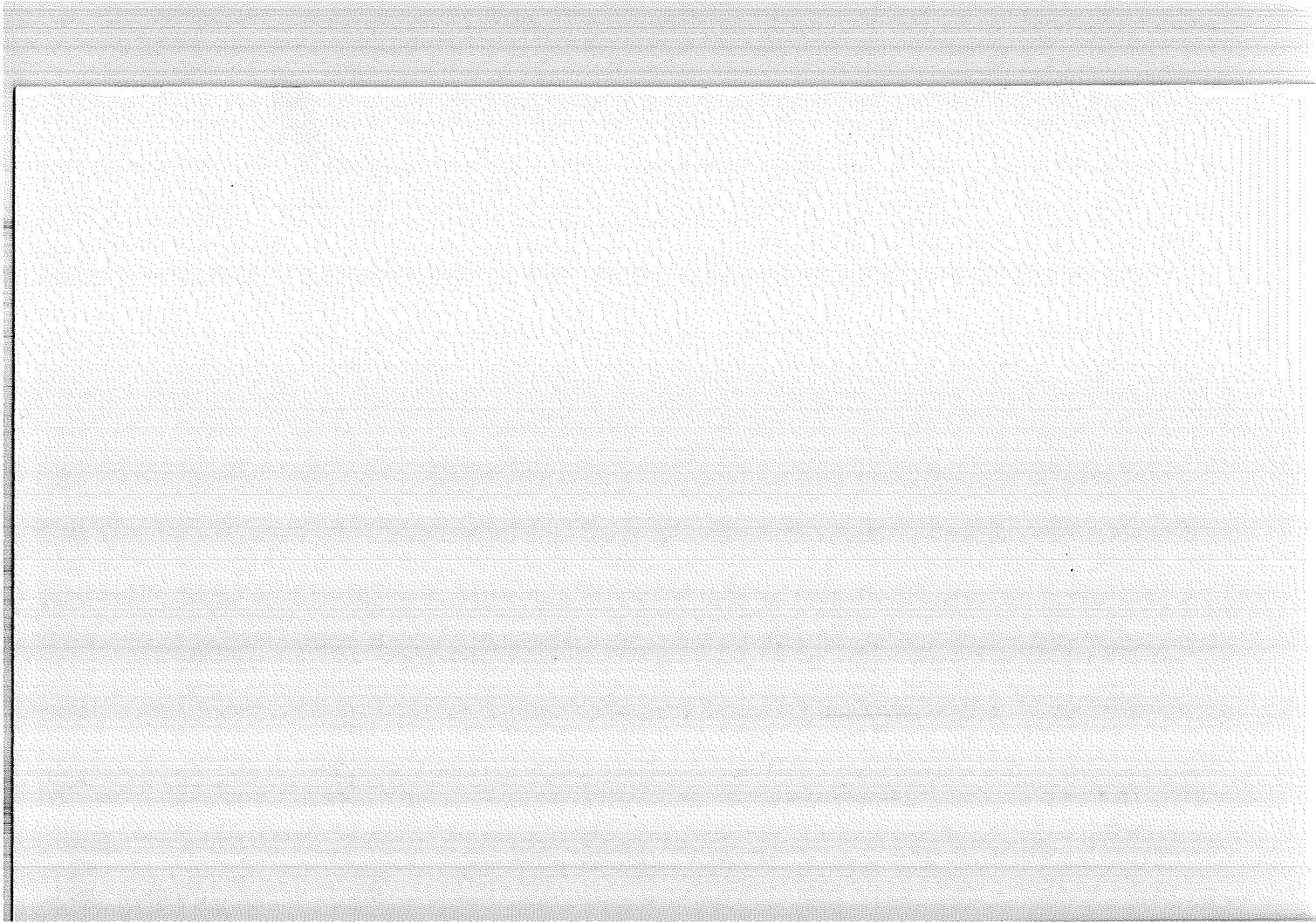

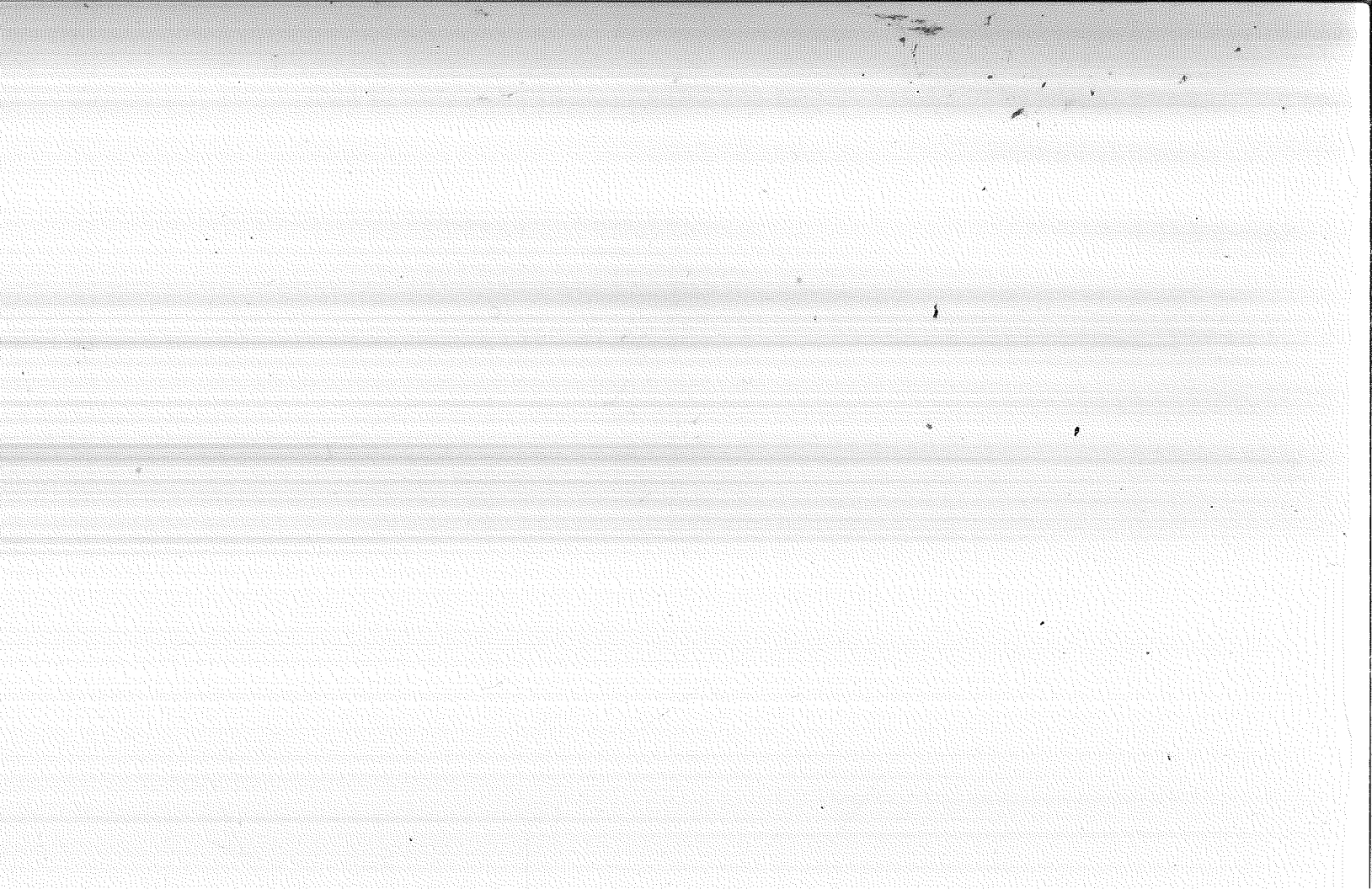

Index
File No. T-13

CORNER RECORD (SEARCH)
(Ref. FSM 7151.4)

Tract or
Survey No. _____ Cor. No. T-13

T 23S R. 16E

R.D. _____ County Lakes

Merid. Will

N.F. Deschutes State Oregon

CORNER DIAGRAM

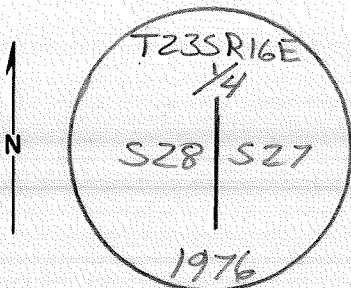

DESCRIBE CORNER MONUMENT FOUND

AT ORIG $\frac{1}{4}$ Cor Secs 27+28, Mon. By John W. McDrum in 1882 with a Basalt Stone, 17x12"x6", Found Buried completely underground 3" Below Surface, MKD $\frac{1}{4}$ on West Face

DESCRIBE BEARING TREES OR OTHER OFFICIAL ACCESSORIES FOUND

A Pine, 27" Dia, Brs. N 78° W, 331Ks Dist, with scribe MKs " $\frac{1}{4}$ s BT" Visible on open + Partially Burned Double Face.
S.W. BT. Gone.

DESCRIBE CORNER LOCATION RELATIVE TO NEAR-BY FEATURES, ALSO HOW TO REACH CORNER

Cor Falls 11K. East of 4 strand N-S B.W. Fence Line.

PHOTO IDENTIFICATION DATA

Photo No. _____
Filed At. _____
Object Ident. _____
Ident. By _____
Signature

PLANE COORDINATE POSITION DATA

State _____ Zone _____
X _____
Y _____
Estab. By _____
Agency

Signature

Title

Division

Headquarters

Date

7100-52-(3/68)

Dan SanKwich Survey Tech

7/76

CORNER RECORD (PERPETUATION)

MONUMENT : DESCRIBE NEW MONUMENT SET, OR WORK DONE TO PRESERVE EXISTING MONUMENT

AT Cor. PT. Set a 2 1/2" x 28" IP. 24" in GRND.
Orig stone Deposited Alongside IP.

9

ACCESSORIES : DESCRIBE NEW BT's WITNESS OBJECTS ETC. ESTABLISHED, OR WORK DONE TO PRESERVE EXISTING EVIDENCE

A Pine, 8", Brs. S 79° E, 118 Ks., MKd 1/4 S 27 BT.

B.T. Tags Posted

10

Work Done By Joe Garrison Title BLM Date 7/76 State Registration No. ,
or Agency _____

Certified Cor. Record Prepared ? Yes No Filed At: _____ Date _____

11

REMARKS

Index File No.

T.

R.

M.

Tract or Surv. No.

Cor.

T-13

12

13

Index
File No. 0171

CORNER RECORD (SEARCH)

(Ref. FSM 7151.4)

Contract or

Survey No.

000832

Cor.

No.

V-01

T 23 S. R. 16 E. R.D.

Ft Rock

County

Lake

NW

Cor. of

Merid. WILLAMETTE

N.F.

DESCHUTES

State

OREGON

Section

31

SEE: V-25 T. 23 S., R. 15 E., W.M.

BCSP

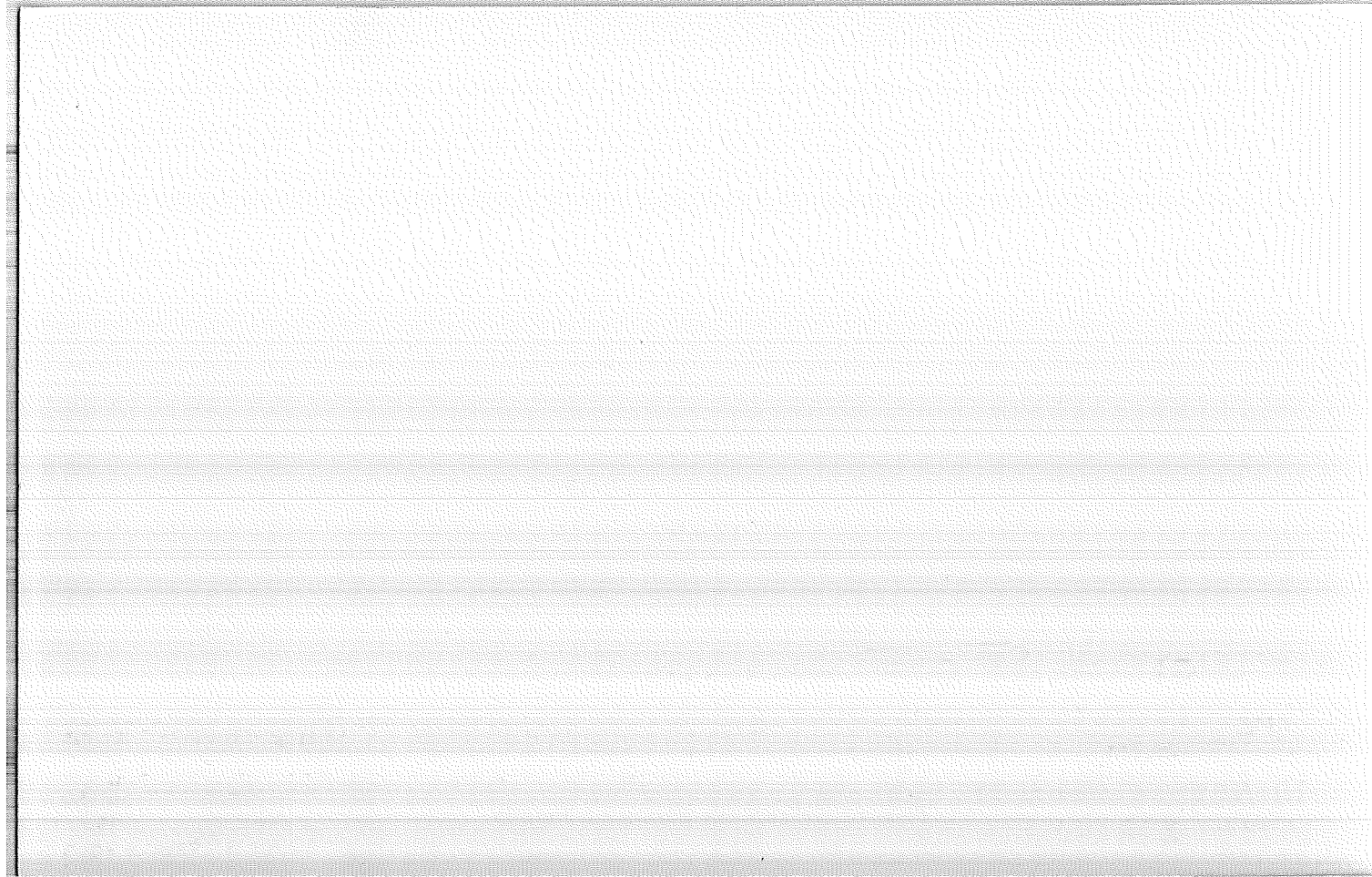

LAND CORNER RECORD

(Rectangular)

V-9 5680-2

1. T 23S R 16E No. V-9 Cor. Sec Mer. Wm. State Oregon N. F. Deschutes Dist. Fort Rock

2. Corner Status _____

3. Original Description _____ Vol. _____ Page _____ Where Recorded _____

4. Description of Corners: _____

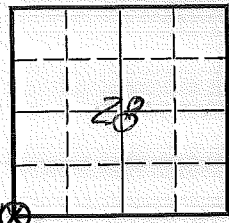

5. Investigation Notes:

B.T. Sec. 29 16" P.P. bearing N40W dist. 51'
 Sec. 33 20" P.P. " S10E dist. 36'
 Metal poster on N. side of 6" tree

7. Photo Identification
 Photo No. _____
 Ident. By: _____

8. Plane Coordinate Position Data
 State _____ Zone _____
 X _____
 Y _____
 Estab. By _____
 Field Book No. _____
 Where Filed _____

9. Evaluation
 Authentic _____
 Needs Verif. _____ Monument No
 Re-estab. X Survey _____
 Land Status F.S.

6. Signed M.L.C. Title _____ Date 1959

PERPETUATION RECORD

10. Monument:

11. Accessories

Field Book _____ Page _____

12. Set By _____ Title _____

License _____ Agency _____ Date _____

13. Recorded By _____ (Agency) _____ Volume _____ Page _____

(Date) _____ (City) _____ (County) _____ (State) _____

14. Remarks:

USDA-FOREST SERVICE

Index

File No. 0173

CORNER RECORD (SEARCH)

(Ref. FSM 7151.4)

Contract or

Survey No.

000832

Cor.

No.

X-01T 23 S. R. 16 E. R.D.Ft Rock

County

LakeW/4

Cor. of

Merid. WILLAMETTE N.F.DESCHUTES

State

OREGON

Section

31SEE: X-25 T. 23 S., R. 15 E., W.M.

BCSP



USDA-FOREST SERVICE

Index
File No. 0375

CORNER RECORD (SEARCH)
(Ref. FSM 7151.4)

Tract or Survey No. 000805 Cor. No. 2-03

T 23 S R. 16 E. R.D. Ft. Rock County Lake SC S/4 S.31

Merid. Wm N.F. DES State OR

CORNER DIAGRAM

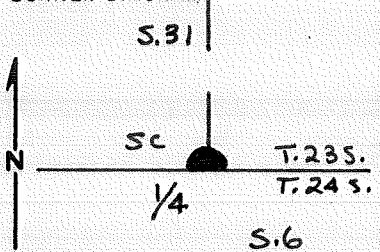

R.16 E. 6

PHOTO IDENTIFICATION DATA

Photo No. _____
Filed At. _____
Object Ident. _____
Ident. By _____
Signature 7

PLANE COORDINATE POSITION DATA

State _____ Zone _____
X _____
Y _____
Estab. By _____
Agency 8

DESCRIBE CORNER MONUMENT FOUND

Find a well bedded stone 12x10x7 mkd per record

DESCRIBE BEARING TREES OR OTHER OFFICIAL ACCESSORIES FOUND

29" P. pine in SW location that was chopped open previously with visible "S" scribing.

18" P. pine in NE location that was healed over.

DESCRIBE CORNER LOCATION RELATIVE TO NEAR-BY FEATURES, ALSO HOW TO REACH CORNER

Signature
W. Miller

Title
PLS.

Division
CS

Headquarters
SO

Date
11/89

FS-7100-52 (3/68)

CORNER RECORD (PERPETUATION)

MONUMENT: DESCRIBE NEW MONUMENT SET, OR WORK DONE TO PRESERVE EXISTING MONUMENT

Set 2 1/2" BCSP rising 8" in place of orig. stone
which was buried along the East side of the cap.

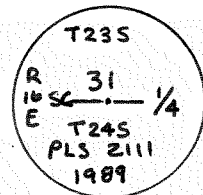

ACCESSORIES : DESCRIBE NEW BT'S WITNESS OBJECTS ETC. ESTABLISHED, OR WORK DONE TO PRESERVE EXISTING EVIDENCE

- A 10" P. pine brs N 20° 09' E @ 83.7' B/S X BT
- A 17" P. pine brs N 63° 34' W @ 77.3' B/S SC 1/4 S 31 BT
- A 29" P. pine brs N 89° 53' W @ 61.5' (orig.)
- AN 18" P. pine brs N 32° 47' E @ 55.9' (orig.)

Work Done By W. Miller Title PLS Date 11/89 State Registration No. 2111
or Agency _____
Certified Cor. Record Prepared? Yes No Filed At: Lake Co. Date 4/14/90

REMARKS

Index File No. 0375 T. 23 R. 16 M. GPO: 1986 0- 439-095 Tract or Surv. No. _____ Cor. 2-03

USDA-FOREST SERVICE

Index
File No. 0577

CORNER RECORD (SEARCH)
(Ref. FSM 7151.4)

Tract or Survey No. 000805 Cor. No. Z-05

T 23 S R. 16 E. R.D. Ft. Rock County Lake SW SC COR

Merid. Wm N.F. Des State OR Sec. 32

CORNER DIAGRAM

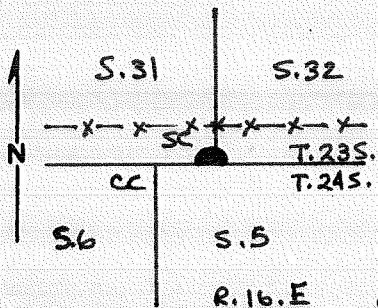

DESCRIBE CORNER MONUMENT FOUND

Fd. Stone 18x12x9 well bedded marked per record call.

DESCRIBE BEARING TREES OR OTHER OFFICIAL ACCESSORIES FOUND

A dead/down pine in NW position, No visible marks
A 34" P. pine in NW position, healed over.
A p. pine stump in SE position w/low axe mark.
An uprooted pine stump in the approx. SW position with visible scribing.

PHOTO IDENTIFICATION DATA

Photo No. _____
Filed At. _____
Object Ident. _____
Ident. By _____
Signature

PLANE COORDINATE POSITION DATA

State _____ Zone _____
X _____
Y _____
Estab. By _____
Agency

DESCRIBE CORNER LOCATION RELATIVE TO NEAR-BY FEATURES, ALSO HOW TO REACH CORNER

1.30 chs. East of 6/5 cc,
1.5 ft South of E-W B/W fence

Signature
W Miller

Title
PLS

Division
CS

Headquarters
SO

Date
4/30 11/89

FS-7100-52 (3/68)

CORNER RECORD (PERPETUATION)

MONUMENT: DESCRIBE NEW MONUMENT SET, OR WORK DONE TO PRESERVE EXISTING MONUMENT

Set 2 1/2" BCSP RISING 4" in place of original stone which was buried on East side of cap.

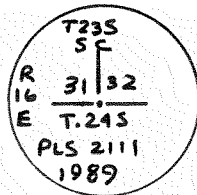

ACCESSORIES : DESCRIBE NEW BT'S WITNESS OBJECTS ETC. ESTABLISHED, OR WORK DONE TO PRESERVE EXISTING EVIDENCE

- AN 8" P. pine brs N64°37'E @ 179.8' B/S T235 R16E S32 SC BT
- A 20" P. pine brs S 20°08'E @ 139.7' B/S T245 R16E 55 BT
- A 17" P. pine brs N 12°33'E @ 132.8' B/S T235 R16E S32 SC BT
- A 2 1/2" BC (orig. CC location to S. 5, 6) brs S 89°26' 32" W @ 86.91'

Work Done By W. Miller Title PLS Date 11/89 State Registration No. 2111
or Agency

Certified Cor. Record Prepared? No Filed At: LAKE CO. Date 4/14/90

REMARKS

Index File No. 0575 T. 23 R. 16 M. Tract or Surv. No.

USDA-FOREST SERVICE

Index

File No. 0775

CORNER RECORD (SEARCH)

(Ref. FSM 7151.4)

Tract or

Survey No. _____ Cor. No. 2-07

T 23 S R. 16 E

R.D. Ft. Rock County Lake

SC S/4 S.32

Merid. Wm

N.F. Des State OR

CORNER DIAGRAM

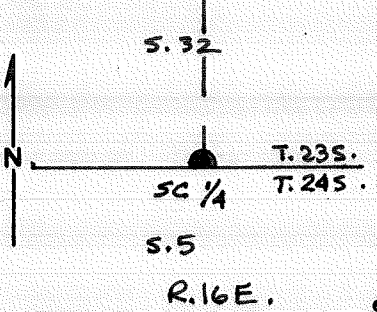

DESCRIBE CORNER MONUMENT FOUND

Fd. Stone 12x10x10 well bedded and marker per Record Call.

2

DESCRIBE BEARING TREES OR OTHER OFFICIAL ACCESSORIES FOUND

SF/NF

3

PHOTO IDENTIFICATION DATA

Photo No. _____
 Filed At. _____
 Object Ident. _____
 Ident. By _____
Signature

DESCRIBE CORNER LOCATION RELATIVE TO NEAR-BY FEATURES, ALSO HOW TO REACH CORNER

Monument is set in an E-W running B/W fence

4

PLANE COORDINATE POSITION DATA

State _____ Zone _____
 X _____
 Y _____
 Estab. By _____
Agency

Signature
W. Miller

Title
PLS

Division
CS

Headquarters
SO

Date
11/89

FS-7100-52 (3/68)

5

CORNER RECORD (PERPETUATION)

MONUMENT: DESCRIBE NEW MONUMENT SET, OR WORK DONE TO PRESERVE EXISTING MONUMENT

Set 2 1/2" x 30" ACAP RISING 8" in place of orig. stone
which was buried along the west side of cap.

T235
 SC
 32
 --- 1/4
 XX
 T245
 PLS 2111
 1989

ACCESSORIES : DESCRIBE NEW BT'S WITNESS OBJECTS ETC. ESTABLISHED, OR WORK DONE TO PRESERVE EXISTING EVIDENCE

5/8" rebar w/1 1/2" AC MKd BO S32 PLS 2111 1989 bRS N 31°11'E @ 50.56'
 " " " " " BO S5 PLS 2111 1989 " S 51°01'E @ 50.76'

9

10

Work Done By. W. Miller Title PLS Date 11/89 State Registration No. 2111
 or Agency _____

Certified Cor. Record Prepared? Yes No Filed At: Lake Co. Date 4/14/90

11

REMARKS

Index File No.

T.

R.

M.

Tract or Surv. No.

Cor.

2 0775

23

16

GPO: 1986 O-439-095

2-07

12

13

USDA-FOREST SERVICE

Index
File No. 0975

CORNER RECORD (SEARCH)

(Ref. FSM 7151.4)

Tract or
Survey No. _____

Cor.
No. Z-09

T 23 S R. 16 E

R.D. Ft. Rock County Lake

SE SC S.33

Merid. Wm

N.F. Des State OR

CORNER DIAGRAM

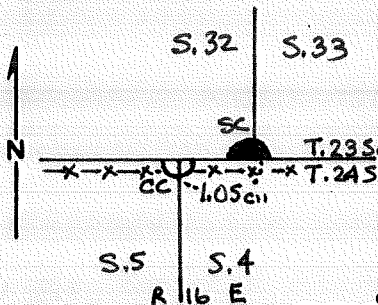

DESCRIBE CORNER MONUMENT FOUND

Fd. well bedded 13x10x8 stone marked per record

DESCRIBE BEARING TREES OR OTHER OFFICIAL ACCESSORIES FOUND

SF/NF

PHOTO IDENTIFICATION DATA

Photo No. _____
Filed At. _____
Object Ident. _____
Ident. By _____
Signature

DESCRIBE CORNER LOCATION RELATIVE TO NEAR-BY FEATURES, ALSO HOW TO REACH CORNER

Mon is 1.5' North of E-W B/W Fence
and 1.05 chs ~~W~~ E'ly of CC S. 4, 5. (69.75')

PLANE COORDINATE POSITION DATA

State _____ Zone _____
X _____
Y _____
Estab. By _____
Agency

Signature

W. Miller

Title
PLS

Division
CS

Headquarters
SO

Date
11/89

FS-7100-52 (3/68)

CORNER RECORD (PERPETUATION)

MONUMENT: DESCRIBE NEW MONUMENT SET, OR WORK DONE TO PRESERVE EXISTING MONUMENT

Set 2 1/2" x 30" BCSP Rising 4" IN place of original stone which was buried along the East side of cap.

T 235	
SC	
R	32 33
16	---
E	XK XK
T 245	
PLS 2111	
1989	

ACCESSORIES : DESCRIBE NEW BT'S WITNESS OBJECTS ETC. ESTABLISHED, OR WORK DONE TO PRESERVE EXISTING EVIDENCE

3/8" REBAR W/1 1/2" AC MKd BO S32 PLS 2111 1989 brs N42°14'W @ 44.90'

" " " " " BO S33 PLS 2111 1989 " N42°05'E @ 52.60'

" " " " " BO S4 PLS 2111 1989 " S44°23'E @ 51.65'

A 2 1/2" BC (orig. cc to S, 4, 5) brs N89°40'24"W @ 69.75'

Work Done By W. Muller Title PLS Date 11/89 State Registration No. 2111
or Agency _____

Certified Cor. Record Prepared? Yes No Filed At: Lake CO Date 4/14/90

REMARKS

Index File No. T. R. M. Tract or Surv. No. Cor. 12
13

0975